



Interval 60 min. 15 min.

Count(volume) Speed

Binned(CL/SP) Raw

Lane No 1 2

Direction Channel 1 _____

Direction Channel 2 _____

Data Hog # 7059

Counter No. 3452 ^{week} 12 Count ID HD115

SR 501 RRT/RRQ _____ MP 2.24

Leg 2 Direction W/B NE OSID _____

Station Description - ON SR 501 N-O SW 26th St. Ext
ON SR 501 W/O SW 26th St Ext

Date	Day	Time	Comments
3/14/05	2	13:45	Manual (1) <u>10</u> (2) _____ Counter (1) <u>10</u> (2) _____ set OK JM/JM 6.4v
3/15	3	0738	Manual (1) <u>13</u> (2) _____ Counter (1) <u>13</u> (2) _____ check o.k. JM/JM 6.4
3/16	4	1126	Manual (1) <u>8</u> (2) _____ Counter (1) <u>8</u> (2) _____ check o.k. JM/JM 6.4
3/17	5	0919	Manual (1) <u>12</u> (2) _____ Counter (1) <u>12</u> (2) _____ called long 3-6/3-4 called 7-10/7-13 otherwise OK JM/JM 6.4
3/19	6	0841	Manual (1) <u>13</u> (2) _____ Counter (1) <u>13</u> (2) _____ PU o.k. JM/JM 6.4

Sketch

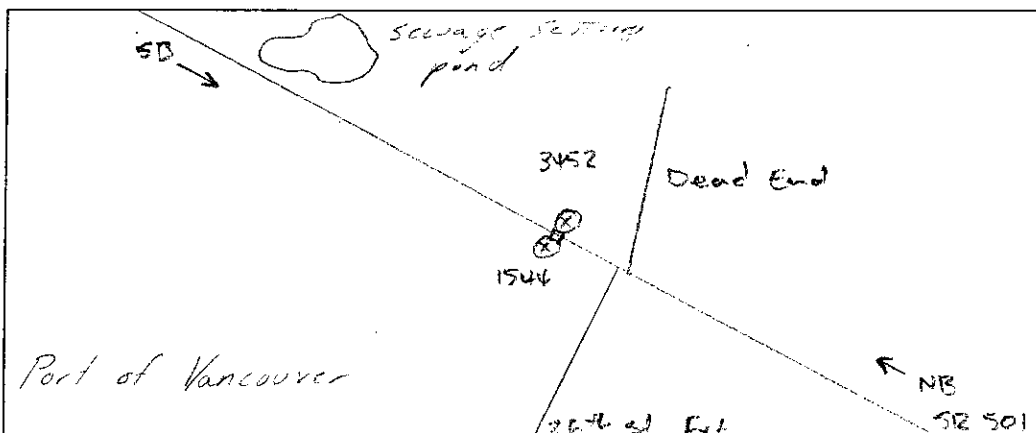

North

JTM/JM

Field Person



Interval 60 min. 15 min.

Count(volume) Speed

Binned(CL/SP) Raw

Lane No 1 2

Direction Channel 1 _____

Direction Channel 2 _____

Data Hog # 7059

Counter No. 1544 ^{week} 12 Count ID HDMS

SR 501 RRT/RRQ _____ MP 2.24

Leg 2 Direction EB OSID _____

Station Description - ON SR 501 N-SW 26th St. Ext
On SR 501 W/O SW 26th St Ext

Date	Day	Time	Comments
3/14/05	2	13:47	Manual (1) <u>5</u> (2) _____ Counter (1) <u>5</u> (2) _____ set OK JM/JM 6.3
3/15	3	0745	Manual (1) <u>4</u> (2) _____ Counter (1) <u>4</u> (2) _____ check o.k. JM/JM 6.3
3/16	4	1112	Manual (1) <u>12</u> (2) _____ Counter (1) <u>12</u> (2) _____ check o.k. JM/JM 6.3
3/17	5	0924	Manual (1) <u>14</u> (2) _____ Counter (1) <u>14</u> (2) _____ check OK JM/JM 6.3
3/18	6	0847	Manual (1) <u>6</u> (2) _____ Counter (1) <u>6</u> (2) _____ PU o.k. JM/JM 6.3

Sketch

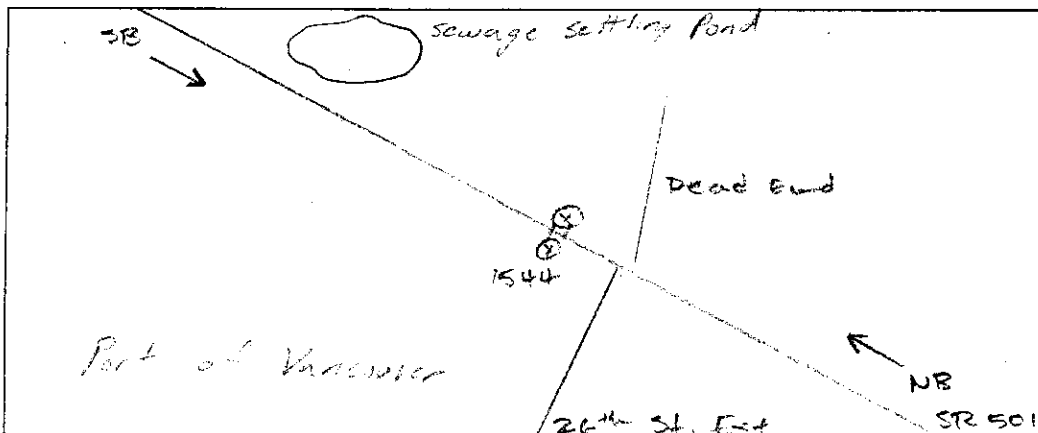

North

JM/JM

Field Person

STATE OF WASHINGTON - DEPARTMENT OF TRANSPORTATION
 TRIP SYSTEM
 HOURLY TRAFFIC CLASSIFICATION SUMMARY

SR 501	MP 002.24	OFF SYSTEM ID.	LEG 2	DIRECTION OF TRAFFIC	WESTBOUND	LANE ALL OF													
COUNT IDENTIFIER	HPMS	COUNTER NUMBER	003452	DESCRIPTION: ON SR 501 W/O SW 26TH ST EXT															
03-14-05																			
MONDAY	CARS PICKUPS	BUS	SINGLE MED	HVY	4+	SINGLE UNIT %	DOUBLE UNITS 4-	5	6+	DOUBLE UNIT %	5-	TRAINS 6	7+	TRAIN %	TRUCK %	CLASS UNKNOWN	TOTAL VEHICLES		
12 - 1	1																	1	193
1 - 2	2																		151
2 - 3	3																		110
3 - 4	4																		97
4 - 5	5																		55
5 - 6	6																		21
6 - 7	7																		26
7 - 8	8																		15
8 - 9	9																		10
9 - 10	10																		14
10 - 11	11																		14
11 - 12	12																		14
AM TOTAL	534	4	60	17	17	11.7	4	26	26	8.1	1	1	18	2.7	22.5	2	692		
PM TOTAL	534	4	60	17	17	11.7	4	26	26	8.1	1	1	18	2.7	22.5	2	692		
DAY TOTAL	534	4	60	17	17	11.7	4	26	26	8.1	1	1	18	2.7	22.5	2	692		
																			843

2-AXLE EQUIVALENT

SR 501 MP 002.24

OFF SYSTEM ID.

LEG 2

DIRECTION OF TRAFFIC WESTBOUND

LANE ALL OF

COUNT IDENTIFIER HPMS

COUNTER NUMBER 003452

DESCRIPTION: ON SR 501 W/O SW 26TH ST EXT

03-15-05 TUESDAY AM HOURS 12 - 1	CARS PICKUPS	BUS	SINGLE MED	UNITS HYV	4+	SINGLE UNIT %	DOUBLE 4-	DOUBLE 5	DOUBLE 6+	DOUBLE UNIT %	5-	TRAINS 6	TRAINS 7+	TRAIN %	TRUCK %	CLASS UNKNOWN	TOTAL VEHICLES
1	8					22.2									33.3		8
2	6					28.6									42.9		7
3	4					28.6									28.6		14
4	10					19.5									26.8		41
5	30					14.8									24.1		54
6	41					9.6									19.9		156
7	125					11.1									24.6		171
8	127					12.6									34.4		151
9	98					18.2									41.4		181
10	104					28.7									44.3		167
11	93					23.8									35.6		160
12	101					18.0									36.6		183
PM HOURS						14.0									28.0		200
1	116					23.7									39.6		169
2	143					17.1									31.5		146
3	102					8.8									18.6		102
4	98					6.0									15.4		117
5	83					6.4									11.4		44
6	97					2.3									5.3		38
7	40					2.6									13.0		23
8	39					4.3									21.4		14
9	36					5.3									5.3		19
10	20					12									5.5		7
11	11					9.7									3.3		5
12	18					9.7									26.7		1102
AM TOTAL	747					15.6									29.7		1119
PM TOTAL	803					9.7									26.7		1102
DAY TOTAL	1550					9.7									29.7		2221

2-AXLE EQUIVALENT

SR 501 MP 002.24 OFF SYSTEM ID. LEG 2 DIRECTION OF TRAFFIC WESTBOUND LANE ALL OF

COUNT IDENTIFIER HPMS COUNTER NUMBER 003452 DESCRIPTION: ON SR 501 W/O SW 26TH ST EXT

03-16-05 WEDNESDAY AM HOURS	CARS PICKUPS	BUS	SINGLE UNITS			DOUBLE UNITS			TRAINS	7+	TRAIN %	TRUCK %	CLASS UNKNOWN	TOTAL VEHICLES	
			MED	HVY	4+	4-	5	6+							UNIT %
12 - 1	7													7	
1 - 2	2													5	
2 - 3	6													7	
3 - 4	10													15	
4 - 5	31													40	
5 - 6	39		2		4									52	
6 - 7	124		1		7									153	
7 - 8	121		1		10									177	
8 - 9	92		3		8									143	
9 - 10	92		2		19									160	
10 - 11	88		2		23									169	
11 - 12	83		1		21									146	
PM HOURS															
12 - 1	113		1		22									188	
1 - 2	119		1		22									177	
2 - 3	90		1		23									145	
3 - 4	94				23									151	
4 - 5	57		1		9									79	
5 - 6	50				9									62	
6 - 7	40				3									47	
7 - 8	21				3									22	
8 - 9	18				2									18	
9 - 10	18				1									19	
10 - 11	8				1									10	
11 - 12	11		1		1									13	
AM TOTAL	695		12		92									1074	
PM TOTAL	639		5		105									931	
DAY TOTAL	1334		17		197									2005	
2-AXLE EQUIVALENT														11	2739

HOURLY TRAFFIC CLASSIFICATION SUMMARY

SR 501 MP 002.24 OFF SYSTEM ID. LEG 2 DIRECTION OF TRAFFIC WESTBOUND LANE ALL OF

COUNT IDENTIFIER HPMS COUNTER NUMBER 003452 DESCRIPTION: ON SR 501 W/O SW 26TH ST EXT

03-17-05 THURSDAY AM HOURS	CARS PICKUPS	BUS	MED	SINGLE UNITS HVV	4+ SINGLE UNIT %	DOUBLE UNITS 4-	5 DOUBLE UNITS 6+	DOUBLE UNITS UNIT %	5- TRAINS	6 TRAINS 7+	TRAIN %	TRUCK %	CLASS UNKNOWN	TOTAL VEHICLES
1	9				25.0			10.0				10.0		10
2	4							12.5				50.0		8
3	3							20.0				50.0		5
4	6				38.5			7.7				46.2		13
5	26				19.4			2.8				27.8		36
6	53				9.7			3.2				14.5		62
7	118				12.3			9.1				23.4		154
8	134				12.2			9.4				26.0		181
9	83				18.5			21.6				40.3		139
10	78				20.7			19.3				42.2		135
11	93				21.3			12.8				45.0		169
12	108				16.0			10.5				42.0		188
1	125				13.9			13.9				30.9		181
2	112				27.4			8.9				32.1		165
3	99				19.9			10.5				39.9		168
4	122				10.1			9.2				32.6		181
5	84				7.1			4.3				21.1		109
6	58				7.7			7.7				12.9		70
7	42				10.0			2.9				17.3		52
8	35				2.9							10.0		40
9	32											5.7		35
10	13													14
11	18													14
12	14													14
AM TOTAL	715				16.3			13.6				34.7		1100
PM TOTAL	754				15.2			9.0				26.9		1047
DAY TOTAL	1469				15.7			11.4				30.9		2147
														2824

2-AXLE EQUIVALENT

SR 501 MP 002.24 OFF SYSTEM ID. LEG 2 DIRECTION OF TRAFFIC WESTBOUND LANE ALL OF
 COUNT IDENTIFIER HPMS COUNTER NUMBER 003452 DESCRIPTION: ON SR 501 W/O SW 26TH ST EXT

03-18-05	CARS PICKUPS	BUS	SINGLE MED	HVY	4+	SINGLE UNIT %	DOUBLE 4-	5	6+	DOUBLE UNIT %	5-	TRAINS 6	7+	TRAIN %	TRUCK 25.0	CLASS UNKNOWN	TOTAL VEHICLES
FRIDAY AM HOURS	9	1	1	1	4	8.3	1	1	1	8.3	1	1	1	8.3	25.0	1	12
12 - 1	4					33.3							2	16.7	33.3		6
1 - 2	9					30.0							2	16.7	30.0		12
2 - 3	7					17.1							2	4.9	16.7		10
3 - 4	30					7.4							2	3.7	26.8		41
4 - 5	45					9.4							2	3.5	14.8		54
5 - 6	141					8.8							5	3.5	16.5		170
6 - 7	136												1	3.5	20.0		170
7 - 8																	
8 - 9																	
9 - 10																	
10 - 11																	
11 - 12																	
AM TOTAL	381	3	17	25	3	10.1	9	15	1	5.1	1	18	1	4.0	19.2	3	475
PM TOTAL	381	3	17	25	3	10.1	9	15	1	5.1	1	18	1	4.0	19.2	3	475
DAY TOTAL	381	3	17	25	3	10.1	9	15	1	5.1	1	18	1	4.0	19.2	3	581

03-14-05 THRU 03-18-05

AVERAGE WEEKDAY CLASSIFICATION VOLUMES	CARS PICKUPS	BUS	SINGLE MED	HVY	4+	SINGLE UNIT %	DOUBLE 4-	5	6+	DOUBLE UNIT %	5-	TRAINS 6	7+	TRAIN %	TRUCK 25.0	CLASS UNKNOWN	TOTAL VEHICLES
AVG WEEKDAY VOLUME	1451	15	207	105	9	15.8	15	106	103	10.5	1	1	99	4.8	31.1	12	2124
TOTAL HOURS FOR COUNT	90																2817

3 DAYS AVG WEEKDAY VOL 2124 X SEASONAL ADJ. FACTOR 0.9900 = ESTIMATED AVG DAILY TRAFFIC 2103

STATE OF WASHINGTON - DEPARTMENT OF TRANSPORTATION
 TRIP SYSTEM
 HOURLY TRAFFIC CLASSIFICATION SUMMARY

SR 501	MP 002.24	OFF SYSTEM ID.	LEG 2	DIRECTION OF TRAFFIC	EASTBOUND	LANE ALL	OF											
COUNT IDENTIFIER	HPMS	COUNTER NUMBER	001544	DESCRIPTION:	ON SR 501 W/O SW 26TH ST EXT													
03-14-05																		
MONDAY																		
AM HOURS	CARS PICKUPS	BUS	SINGLE MED	UNITS HVY	4+	SINGLE UNIT %	DOUBLE UNITS 4- 5 6+	DOUBLE UNIT %	5- TRAINS 6 7+	TRAIN %	TRUCK %	CLASS UNKNOWN	TOTAL VEHICLES					
12 - 1	1																	
1 - 2	2																	
2 - 3	3																	
3 - 4	4																	
4 - 5	5																	
5 - 6	6																	
6 - 7	7																	
7 - 8	8																	
8 - 9	9																	
9 - 10	10																	
10 - 11	11																	
11 - 12	12																	
PM HOURS																		
12 - 1	1																	
1 - 2	2																	
2 - 3	3																	
3 - 4	4																	
4 - 5	5																	
5 - 6	6																	
6 - 7	7																	
7 - 8	8																	
8 - 9	9																	
9 - 10	10																	
10 - 11	11																	
11 - 12	12																	
AM TOTAL	882	1	80	16		9.2	3	23	35	5.8		2	14	1.5	16.5	1	1057	
PM TOTAL	882	1	80	16		9.2	3	23	35	5.8		2	14	1.5	16.5	1	1057	
DAY TOTAL	882	1	80	16		9.2	3	23	35	5.8		2	14	1.5	16.5	1	1057	
																		1212

2-AXLE EQUIVALENT

SR 501 MP 002.24 OFF SYSTEM ID. LEG 2 DIRECTION OF TRAFFIC EASTBOUND LANE ALL OF

COUNT IDENTIFIER HPMS COUNTER NUMBER 001544 DESCRIPTION: ON SR 501 W/O SW 26TH ST EXT

03-15-05 TUESDAY AM HOURS	CARS PICKUPS	BUS	SINGLE MED	HVV	4+	SINGLE UNIT %	DOUBLE 4-	5	6+	DOUBLE UNIT %	5-	TRAINS 6	7+	TRAIN %	TRUCK %	CLASS UNKNOWN	TOTAL VEHICLES
12 - 1	24					11.1			1	9.1			2	7.7	9.1		11
1 - 2	10					28.6				11.1			3	7.7	55.6		9
2 - 3	4					19.0				14.3			1	9.3	42.9		7
3 - 4	4					21.6				8.1			2	9.3	42.9		9
4 - 5	12					27.1				4.2			8	9.3	51.4		21
5 - 6	18		2			18.2				21.2			5	10.4	41.7		37
6 - 7	28		4			13.2				19.8			11	16.7	56.1		48
7 - 8	29		6		2	24.3				13.9			10	12.1	47.0		66
8 - 9	50		2			32.5				14.4			10	8.7	53.8		91
9 - 10	61		12			19.9				8.4			10	6.9	33.0		115
10 - 11	74		32										8	4.7			160
11 - 12	128		22										1				191
PM HOURS																	
12 - 1	126		2			14.8				12.2			11	6.3	33.3		189
1 - 2	159		1			14.2				6.4			13	6.4	26.9		219
2 - 3	129		26			18.6				8.0			8	4.8	31.4		188
3 - 4	137		30			20.1				4.3			2	1.1	25.5		184
4 - 5	172		15			8.4				5.4			1	1.5	14.4		202
5 - 6	170		7			3.7				2.7			4	2.7	9.1		187
6 - 7	96		5			4.5				6.4			1	10.9	10.9		110
7 - 8	40		2			6.3				10.4			1	16.7	16.7		48
8 - 9	33		1			2.6				2.9			1	5.7	5.7		35
9 - 10	37		1			7.7				2.6			1	5.1	5.1		39
10 - 11	11		1			5.3				7.7			1	15.4	15.4		13
11 - 12	18														5.3		19
AM TOTAL	442		80			21.7				12.4			2	9.3	43.5		782
PM TOTAL	1128		130			11.6				6.4			3	3.1	21.0		1433
DAY TOTAL	1570		210			15.2				8.5			6	5.3	28.9		2215
			4										109		2-AXLE EQUIVALENT		2894

SR 501 MP 002.24 OFF SYSTEM ID. LEG 2 DIRECTION OF TRAFFIC EASTBOUND LANE ALL OF

COUNT IDENTIFIER HPMS COUNTER NUMBER 001544 DESCRIPTION: ON SR 501 W/O SW 26TH ST EXT

03-16-05	CARS PICKUPS	BUS	SINGLE MED	UNITS HVY	4+	SINGLE UNIT %	DOUBLE 4-	UNITS 5	6+	DOUBLE UNIT %	5-	TRAINS 6	7+	TRAIN %	TRUCK %	CLASS UNKNOWN	TOTAL VEHICLES
WEDNESDAY	26		1			25.0		1	1	6.7			2	6.7	13.3		30
AM HOURS	3														25.0		4
12 - 1	6					11.1		1		9.1			4	36.4	45.5		11
2 - 2	8					27.8		1		5.6			4	22.2	55.6		9
3 - 3	8					23.5		4		11.8			6	17.6	52.9		18
4 - 4	16		1			16.7		5		10.4			3	6.3	33.3		34
5 - 5	32		3			17.2		15		27.6			12	13.8	58.6		48
6 - 6	35		3			19.2		7		19.2			8	10.3	48.7		87
7 - 7	39		8			22.8		11		17.9			12	10.6	51.2		78
8 - 8	60		11			22.8		11		15.5			16	10.8	48.6		123
9 - 9	76		21			22.3		10		10.8			13	8.4	42.2		148
10 - 10	96		26			22.9	2	8	8	10.8		1	13	8.4	42.2		166
11 - 11																	
PM HOURS																	
12 - 12	126		24			17.2	1	11	8	10.1			17	8.6	35.9	1	198
1 - 1	126		20			16.5		8	7	8.0			14	7.4	31.9	2	188
2 - 2	100		29			21.3		11	8	11.9			7	4.4	37.5		160
3 - 3	148		14			15.0		11	7	8.7			9	4.4	28.2		206
4 - 4	148		1			9.7		8	8	8.6			2	1.1	19.5	1	185
5 - 5	114		3			2.5		2	1	2.5		1		5.8	9.5		121
6 - 6	86		4			5.3	1	4	1	4.2				11.1	13.3		95
7 - 7	39		1			2.2		4		11.1				7.4	11.1		45
8 - 8	16		1			5.6		1		5.6				3.7	7.4		18
9 - 9	25					3.7		1		3.7				9.1	18.2		27
10 - 10	9					9.1		1		9.1							11
11 - 11	13																13
AM TOTAL	405		74			20.1		63	50	15.2			80	10.8	46.2	2	756
PM TOTAL	950		126			12.6		60	41	8.1			49	3.9	24.7	4	1267
DAY TOTAL	1355		200			15.4		123	91	10.8			129	6.5	32.7	6	2023
																	2779

2-AXLE EQUIVALENT

SR 501 MP 002.24 OFF SYSTEM ID. LEG 2 DIRECTION OF TRAFFIC EASTBOUND LANE ALL OF

COUNT IDENTIFIER HPMS COUNTER NUMBER 001544 DESCRIPTION: ON SR 501 W/O SW 26TH ST EXT

03-17-05	CARS PICKUPS	BUS	SINGLE MED	HVY	4+	SINGLE UNIT %	DOUBLE 4-	5	6+	DOUBLE UNIT %	5-	TRAINS 6	7+	TRAIN %	TRUCK %	CLASS UNKNOWN	TOTAL VEHICLES
THURSDAY	24																27
12 - 1	9					22.2				3.7			2	7.4	11.1		9
1 - 2	2					33.3				6.7			5	71.4	71.4		7
2 - 3	7					19.4				12.9			3	20.0	22.2		9
3 - 4	2					25.0				11.5			3	19.4	60.0		15
4 - 5	6					19.1				23.5			6	9.6	51.6		31
5 - 6	15					19.1				23.5			3	4.4	47.1		52
6 - 7	28					19.6				19.1			10	10.3	49.5		68
7 - 8	36					21.7				17.4			8	7.0	47.8		97
8 - 9	49					18.7				13.6			10	7.1	43.2		115
9 - 10	59					21.5				13.6			11	5.8	40.8		155
10 - 11	88					15.2				12.4			9	5.1	32.6		191
11 - 12	112					15.2				13.9			5	3.6	32.7		178
PM HOURS	120					19.0				8.0			5	7.4	34.4		165
12 - 1	109					22.7				5.8			11	2.7	31.1		163
1 - 2	107					10.0				6.1			5	1.3	17.5		225
2 - 3	154					4.8				1.2			3	9.6	8.3		229
3 - 4	189					7.1				5.7			1	1.7	6.8		229
4 - 5	132					5.1				5.6			1		11.4		146
5 - 6	76												1		6.8		84
6 - 7	55												1		8.3		59
7 - 8	31												1		11.4		35
8 - 9	40												1		5.6		59
9 - 10	17												1		5.6		40
10 - 11	22												1		5.6		18
11 - 12	22												1		5.6		22
AM TOTAL	435					19.7				15.7			63	8.2	43.7		776
PM TOTAL	1052					12.8				7.0			34	2.7	22.6		1364
DAY TOTAL	1487					15.3				10.2			97	4.7	30.2		2140
															2-AXLE EQUIVALENT		2823

SR 501 MP 002.24 OFF SYSTEM ID. LEG 2 DIRECTION OF TRAFFIC EASTBOUND LANE ALL OF

COUNT IDENTIFIER HPMS COUNTER NUMBER 001544 DESCRIPTION: ON SR 501 W/O SW 26TH ST EXT

03-18-05	CARS PICKUPS	BUS MED	SINGLE UNITS 4+	SINGLE UNIT %	DOUBLE UNITS 4-	DOUBLE UNITS 5	DOUBLE UNITS 6+	DOUBLE UNIT %	5-	TRAINS 6	TRAINS 7+	TRAIN %	TRUCK %	CLASS UNKNOWN	TOTAL VEHICLES
FRIDAY AM HOURS	13														15
12 - 1	6						1	14.3			2	13.3	13.3		7
1 - 2	8					2		14.3			4	28.6	42.9		14
2 - 3	3		1	25.0									25.0		4
3 - 4	9		5	40.0			1	16.2			11	29.7	40.0		15
4 - 5	14		5	16.2		5	2	4.8			2	4.8	62.2		37
5 - 6	30		5	19.0		3	12	18.1			10	12.0	48.2		42
6 - 7	43		5	18.1											83
7 - 8															
8 - 9															
9 - 10															
10 - 11															
11 - 12															
AM TOTAL	126		12	16.6		10	16	12.0			29	13.4	41.9		217
PM TOTAL															
DAY TOTAL	126		12	16.6		10	16	12.0			29	13.4	41.9		217

03-14-05 THRU 03-18-05

AVERAGE WEEKDAY CLASSIFICATION VOLUMES *****
CARS PICKUPS | BUS MED | SINGLE UNITS 4+ | SINGLE UNIT % | DOUBLE UNITS 4- | DOUBLE UNITS 5 | DOUBLE UNITS 6+ | DOUBLE UNIT % | 5- | TRAINS 6 | TRAINS 7+ | TRAIN % | TRUCK % | CLASS UNKNOWN | TOTAL VEHICLES
1471 | 4 | 206 | 99 | 16 | 15.3 | 11 | 107 | 90 | 9.8 | 1 | 4 | 112 | 5.5 | 30.6 | 5 | 2126
AVG WEEKDAY VOLUME
TOTAL HOURS FOR COUNT 90
3 DAYS
AVG WEEKDAY VOL 2126 X SEASONAL ADJ. FACTOR 0.9900 = ESTIMATED AVG DAILY TRAFFIC 2105

AVERAGE WEEKDAY CLASSIFICATION VOLUMES *****
CARS PICKUPS | BUS MED | SINGLE UNITS 4+ | SINGLE UNIT % | DOUBLE UNITS 4- | DOUBLE UNITS 5 | DOUBLE UNITS 6+ | DOUBLE UNIT % | 5- | TRAINS 6 | TRAINS 7+ | TRAIN % | TRUCK % | CLASS UNKNOWN | TOTAL VEHICLES
1471 | 4 | 206 | 99 | 16 | 15.3 | 11 | 107 | 90 | 9.8 | 1 | 4 | 112 | 5.5 | 30.6 | 5 | 2126
AVG WEEKDAY VOLUME
TOTAL HOURS FOR COUNT 90
3 DAYS
AVG WEEKDAY VOL 2126 X SEASONAL ADJ. FACTOR 0.9900 = ESTIMATED AVG DAILY TRAFFIC 2105

STATE OF WASHINGTON - DEPARTMENT OF TRANSPORTATION
 TRIP SYSTEM
 HOURLY TRAFFIC CLASSIFICATION SUMMARY

SR 501 MP 002.24 OFF SYSTEM ID. LEG 2 DIRECTION OF TRAFFIC BOTH WAYS LANE ALL OF
 COUNT IDENTIFIER HPMS COUNTER NUMBER 001544 DESCRIPTION: ON SR 501 W/O SW 26TH ST EXT

03-14-05	CARS PICKUPS	BUS	SINGLE MED	UNITS HVY	4+	SINGLE UNIT %	DOUBLE UNITS 4-	5	6+	DOUBLE UNIT %	5-	TRAINS 6	7+	TRAIN %	TRUCK %	CLASS UNKNOWN	TOTAL VEHICLES
MONDAY AM HOURS	12	1	2	3	4	5	6	7	8	9	10	11	12	13	14	15	16
1	256	4	54	16	19.3	2	18	18	9.9	2	12	3.6	32.8	2	384		
2	309	4	48	11	14.4	2	16	14	7.8	1	10	2.7	24.8	2	411		
3	281	5	14	1	4.7	1	9	11	6.5	5	5	1.6	12.7	3	322		
4	248	6	14	1	5.8	1	3	8	4.3	2	2	.7	10.8	3	278		
5	128	7	8	2	6.7	2	2	8	6.7	1	1	.7	14.1	3	149		
6	68	8	2	2	2.7	1	2	2	4.1	2	2	.7	6.8	3	73		
7	60	9	26	2	9.5	1	1	2	4.8	2	2	8.3	14.3	3	60		
8	26	10	18	2	9.5	1	1	2	4.8	2	2	8.3	14.3	3	27		
9	18	11	22	2	9.5	1	1	2	4.8	2	2	8.3	14.3	3	21		
10	11	12	1416	5	140	33	10.2	7	49	61	6.7	3	32	3	1749		
11	12	1416	5	140	33	10.2	7	49	61	6.7	3	32	3	1749			
AM TOTAL	1416	5	140	33	10.2	7	49	61	6.7	3	32	2.0	18.9	3	1749		
PM TOTAL	1416	5	140	33	10.2	7	49	61	6.7	3	32	2.0	18.9	3	1749		
DAY TOTAL	1416	5	140	33	10.2	7	49	61	6.7	3	32	2.0	18.9	3	1749		

2-AXLE EQUIVALENT

SR 501 MP 002.24 OFF SYSTEM ID. LEG 2 DIRECTION OF TRAFFIC BOTH WAYS LANE ALL OF
COUNT IDENTIFIER HPMS COUNTER NUMBER 001544 DESCRIPTION: ON SR 501 W/O SW 26TH ST EXT

03-15-05 TUESDAY AM HOURS	CARS PICKUPS	BUS	SINGLE UNITS			DOUBLE UNITS			TRAINS			TRAIN %	TRUCK %	CLASS UNKNOWN	TOTAL VEHICLES
			MED	HVY	4+	4-	5	6+	5-	6	7+				
12 - 1	32	1	1	1	1	1	1	1	1	1	1	5.9	5.9	5	34
1 - 2	16											5.0	20.0	1	20
2 - 3	8											6.3	50.0	1	16
3 - 4	14											28.6	16	4	21
4 - 5	42											19.4	4.8	1	21
5 - 6	59	1	3	12	9	1	4	6.5	11.0	10	11.0	6.5	32.3	4	62
6 - 7	153	1	3	12	16	1	5	6.6	4.9	10	11.0	6.6	35.2	4	91
7 - 8	156	1	10	16	19	6	4	4.9	12.2	13	8.0	6.4	25.0	2	204
8 - 9	148	1	18	19	22	17	12	12.2	12.2	18	8.0	8.0	33.3	2	237
9 - 10	165	1	9	29	4	15	22	16.9	14.9	19	8.7	14.9	38.4	1	242
10 - 11	167	1	28	30	11	16	22	14.9	12.2	24	8.1	8.1	43.6	2	296
11 - 12	229	1	65	30	4	11	26	12.2	8.3	1	6.1	6.1	48.9	2	327
PM HOURS			47	24	4	13	11	8.3		14	4.3	4.3	34.2	2	351
12 - 1	242	3	40	12	6	23	20	12.6		21	5.9	5.9	34.9	2	372
1 - 2	302	2	40	14	3	15	14	7.2		24	6.2	6.2	27.4	2	419
2 - 3	231	1	57	16	1	11	18	9.8		15	4.5	4.5	35.3	2	419
3 - 4	235	1	51	8	2	15	8	7.6		6	1.8	1.8	28.2	2	330
4 - 5	255		24	2		8	11	6.3		1	1.0	1.0	15.8	1	304
5 - 6	267		12	2		7	9	5.3		4	1.6	1.6	11.5	2	304
6 - 7	136		8			3	7	7.0		4	1.6	1.6	12.1	2	157
7 - 8	79		3			4	7	8.7		1	1.1	1.1	14.1	2	157
8 - 9	69		1			4	4	2.7		1	1.4	1.4	12.1	2	92
9 - 10	57		2			2	2	2.7		1	1.4	1.4	12.1	2	73
10 - 11	22		2			3	4	4.8		1	1.4	1.4	12.1	2	62
11 - 12	36	1		1		2	4	7.4		1	1.4	1.4	12.1	2	27
AM TOTAL	1189	6	184	157	19	88	98	10.8		1	7.0	7.0	37.1	7	1904
PM TOTAL	1931	8	239	58	12	93	91	7.8		2	3.2	3.2	23.5	9	2535
DAY TOTAL	3120	14	423	215	31	181	189	9.1		3	4.8	4.8	29.3	16	4436
													2-AXLE EQUIVALENT		5785

SR 501 MP 002.24 OFF SYSTEM ID. LEG 2 DIRECTION OF TRAFFIC BOTH WAYS LANE ALL OF
COUNT IDENTIFIER HPMS COUNTER NUMBER 001544 DESCRIPTION: ON SR 501 W/O SW 26TH ST EXT

DAY	AM TOTAL	PM TOTAL	CARS PICKUPS	BUS	SINGLE MED	SINGLE HVY	4+	SINGLE UNIT %	DOUBLE 4-	DOUBLE 5	DOUBLE 6+	DOUBLE UNIT %	5-	TRAINS 6	TRAINS 7+	TRAIN %	TRUCK	CLASS UNKNOWN	TOTAL VEHICLES	
03-16-05																				
WEDNESDAY																				
AM HOURS	12	1	33					11.1		1	1	5.4			2	5.4	10.8		37	
	1	2	5		1										3	33.3	44.4		9	
	2	3	12							1					3	27.8	33.3		18	
	3	4	18												5	8.3	25.0		24	
	4	5	39		2										4	6.9	32.8		58	
	5	6	55		4					1					9	10.5	36.0		86	
	6	7	156		1					7					6	3.0	21.9		201	
	7	8	156		1					13					22	8.3	40.5		264	
	8	9	131		2					25					19	8.3	39.4		221	
	9	10	152		3					16					21	8.6	45.6		283	
	10	11	164		3					21					20	12.2	48.3		317	
	11	12	179		1					18					1	8.7	42.6		312	
PM HOURS															26					
	12	1	239		1					19					32	8.3	37.8		386	
	1	2	245		2					15					27	7.4	32.1		365	
	2	3	190		1					24					13	4.3	37.7		305	
	3	4	242							23					16	4.5	31.7		357	
	4	5	205		2					12					5	1.9	22.0		264	
	5	6	164							6					9	8.0	8.0		264	
	6	7	126							4					4	5.5	7.5		183	
	7	8	60							4					1	7.7	11.3		142	
	8	9	34							4					1	1.5	10.4		67	
	9	10	43							1					1	7.5	5.6		36	
	10	11	17							1					1	2.8	6.5		46	
	11	12	24		1					2					1	9.5	19.0		21	
															1	3.8	7.7		26	
AM TOTAL	1100	1589		14	166	139	10	18.0	5	123	106	12.8		3	157	8.7	39.5		1830	
PM TOTAL				7	231	64	4	13.9	4	111	81	8.9		2	95	4.4	27.3		2198	
DAY TOTAL	2689			21	397	203	14	15.8	9	234	187	10.7		5	252	6.4	32.8	17	4028	
																	2-AXLE EQUIVALENT		5518	

STATE OF WASHINGTON - DEPARTMENT OF TRANSPORTATION
 TRIP SYSTEM
 HOURLY TRAFFIC CLASSIFICATION SUMMARY

SR 501 MP 002.24 OFF SYSTEM ID. LEG 2 DIRECTION OF TRAFFIC BOTH WAYS LANE ALL OF
 COUNT IDENTIFIER HPMS COUNTER NUMBER 001544 DESCRIPTION: ON SR 501 W/O SW 26TH ST EXT

03-17-05 THURSDAY AM HOURS	CARS PICKUPS	BUS	SINGLE MED	SINGLE HVV	4+	SINGLE UNIT %	DOUBLE 4-	DOUBLE 5	DOUBLE 6+	DOUBLE UNIT %	5-	TRAINS 6	TRAINS 7+	TRAIN %	TRUCK %	CLASS UNKNOWN	TOTAL VEHICLES
1	33		1	1		11.8		1	1	5.9			2	5.4	10.8		37
2	5												6	5.9	23.5		17
3	13												1	50.0	50.0		12
4	32		3	7		31.8		2	1	4.5			5	9.8	37.3		22
5	68		3	8		23.5		5	1	3.9			8	7.5	26.9		51
6	146		1	12	2	12.9		12	8	6.5			11	3.9	29.1		93
7	170		2	13	2	15.5		13	18	9.7			17	3.9	31.7		206
8	132		1	19	2	14.1	2	23	20	4.4	1		17	4.4	44.1		249
9	137		1	17	4	15.7	6	21	25	3.3		1	14	7.6	44.8	1	236
10	181		1	12	5	20.0	2	22	26	19.2			18	5.9	44.1		250
11	220		4	20	4	19.8	1	27	22	18.5			26	5.9	44.1	2	324
12	245		1	20	3	21.4		29	12	13.2			17	6.9	41.4		379
PM HOURS																	
1	221		3	16	1	15.6	3	22	21	11.4			12	4.7	31.8		359
2	206		4	13	4	14.5	1	10	17	13.9	1		12	3.9	32.4	2	330
3	276		3	14	1	25.3	3	16	13	8.5		1	9	5.4	37.2	2	331
4	273		1	6		21.4	3	12	10	7.9			5	2.5	31.8	2	406
5	190			1		10.1	2	12	6	7.1			5	1.5	18.6	2	338
6	118			1		5.6		3	2	4.6			1	.5	10.6	3	338
7	90			3		7.4		3	6	3.7			1	.7	11.8	2	216
8	63		3	3		7.1		3	2	4.3			1	1.0	8.1	1	99
9	53					4.3		3		2.8			1		8.6	1	70
10	35							1							2.8		54
11	36																36
12	36																36
AM TOTAL	1150		10	182	118	22	23	127	122	14.5	1	1	115	6.2	38.4	5	1876
PM TOTAL	1806		12	237	76	9	11	98	81	7.9	1	2	63	2.7	24.5	15	2411
DAY TOTAL	2956		22	419	194	31	34	225	203	10.8	2	3	178	4.3	30.6	20	4287

2-AXLE EQUIVALENT

SR 501 MP 002.24 OFF SYSTEM ID. LEG 2 DIRECTION OF TRAFFIC BOTH WAYS LANE ALL OF
 COUNT IDENTIFIER HPMS COUNTER NUMBER 001544 DESCRIPTION: ON SR 501 W/O SW 26TH ST EXT

03-18-05	FRIDAY	AM	CARS PICKUPS	BUS	SINGLE MED	UNITS HVY	4+	SINGLE UNIT %	DOUBLE UNITS	5-	TRAINS	6	7+	TRAIN %	TRUCK %	CLASS UNKNOWN	TOTAL VEHICLES
12 -	12	1	22	1	1	1	4	3.7	1	5	1	6	3	11.1	18.5	1	27
1 -	1	2	10					15.4	2				6	23.1	30.8		13
2 -	2	3	17					7.7	2				6	28.6	28.6		26
3 -	3	4	10					28.6	2				2	30.4	30.4		14
4 -	4	5	39					23.2	2				2	3.6	3.6		56
5 -	5	6	59					11.0	6				13	8.8	14.3		91
6 -	6	7	171	2	12	9	1	11.3	3	5	3	5	8	3.8	3.8		212
7 -	7	8	179		11	16	3	11.9	5	23	1	15	15	6.3	29.2		253
8 -	8	9															
9 -	9	10															
10 -	10	11															
11 -	11	12															
12 -	12	1															
1 -	1	2															
2 -	2	3															
3 -	3	4															
4 -	4	5															
5 -	5	6															
6 -	6	7															
7 -	7	8															
8 -	8	9															
9 -	9	10															
10 -	10	11															
11 -	11	12															
AM TOTAL			507	3	29	48	4	12.1	19	31	1	47	47	6.9	26.3		692
PM TOTAL																	
DAY TOTAL			507	3	29	48	4	12.1	19	31	1	47	47	6.9	26.3	3	692

03-14-05 THRU 03-18-05

AVERAGE WEEKDAY CLASSIFICATION VOLUMES		*****															
CARS PICKUPS	BUS MED	SINGLE UNITS HVY	4+	SINGLE UNIT %	DOUBLE UNITS	5-	TRAINS	6	7+	TRAIN %	TRUCK %	CLASS UNKNOWN	TOTAL VEHICLES				
2922	19	413	204	25	15.6	25	213	193	10.1	2	5	211	18	4250			
TOTAL HOURS FOR COUNT 90																	
AVG WEEKDAY VOL 4250 X SEASONAL ADJ. FACTOR 0.9900 = ESTIMATED AVG DAILY TRAFFIC 4208																	

PEAK HOUR PERCENTAGES: K = 9.86 D = 52.27 T = 27.45
 PEAK HOUR LOCATION : VOLUME = 419 DATE: 03/15/05 TIME: 01:00 PM

0.7525