



Interval  15 MIN  60 MIN  
 Count(volume)  Binned(CL/SP)  
 Speed Lane No  1  2

---

Direction CH #1 \_\_\_\_\_  
 Direction CH #2 \_\_\_\_\_  
 Data Hog # 3165

Counter No. 32-1654 Count ID ATR  
 SR 503 RRT/RRQ \_\_\_\_\_ MP 24.81  
 Leg 2 Direction SB OSID \_\_\_\_\_

Station Description - ON SR 503 N/O NE HEALY RD.

Date	Day	Time	Comments
8/6/07	2	1124	Manual (1) <u>1</u> (2) _____ Counter (1) <u>1</u> (2) _____ Set OK RT 6.2
8/7	3	1119	Manual (1) <u>3</u> (2) _____ Counter (1) <u>3</u> (2) _____ check OK RT 6.1
8/8	4	847	Manual (1) <u>2</u> (2) _____ Counter (1) <u>2</u> (2) _____ check OK RT 6.1
8/9	5		Manual (1) _____ (2) _____ Counter (1) _____ (2) _____ NO Check RT
8/10	6	652	Manual (1) <u>1</u> (2) _____ Counter (1) <u>1</u> (2) _____ PIW OK RT 6.0

Sketch

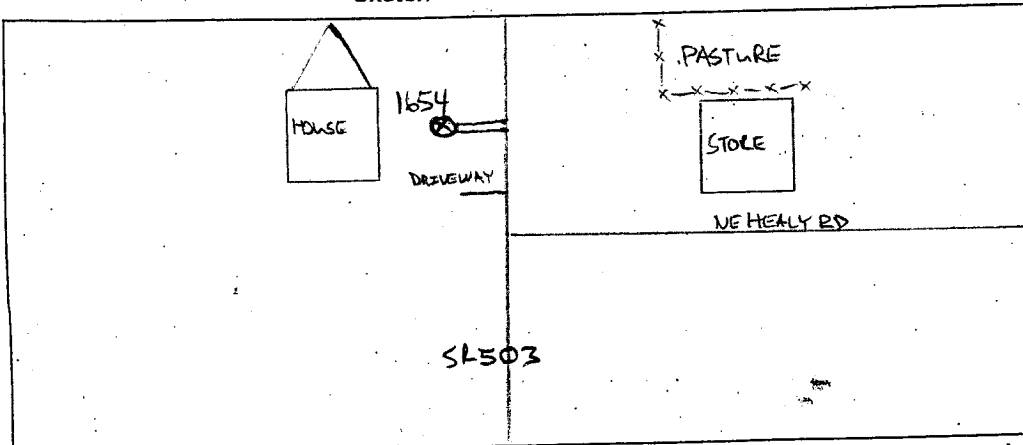

RT

Field Person



Interval  15 MIN  60 MIN  
 Count(volume)  Binned(CL/SP)  
 Speed Lane No  1  2

---

Direction CH #1 \_\_\_\_\_  
 Direction CH #2 \_\_\_\_\_  
 Data Hog # 3165

Counter No. 32-1675 Count ID ATR  
 SR 503 RRT/RRQ \_\_\_\_\_ MP 24.81  
 Leg 2 Direction NB OSID \_\_\_\_\_

Station Description ON SR 503 NB NE HEALY RD.

Date	Day	Time	Comments
8/6/07	2	1114	Manual (1) <u>1</u> (2) _____ Counter (1) <u>1</u> (2) _____ Set OK RT 6.4
8/7	3	1123	Manual (1) <u>2</u> (2) _____ Counter (1) <u>2</u> (2) _____ Check OK RT 6.4
8/8	4	853	Manual (1) <u>4</u> (2) _____ Counter (1) <u>4</u> (2) _____ check OK RT 6.4
8/9	5		Manual (1) _____ (2) _____ Counter (1) _____ (2) _____ NO check RT
8/10	6	703	Manual (1) <u>1</u> (2) _____ Counter (1) <u>1</u> (2) _____ P/W OK RT 6.3

Sketch

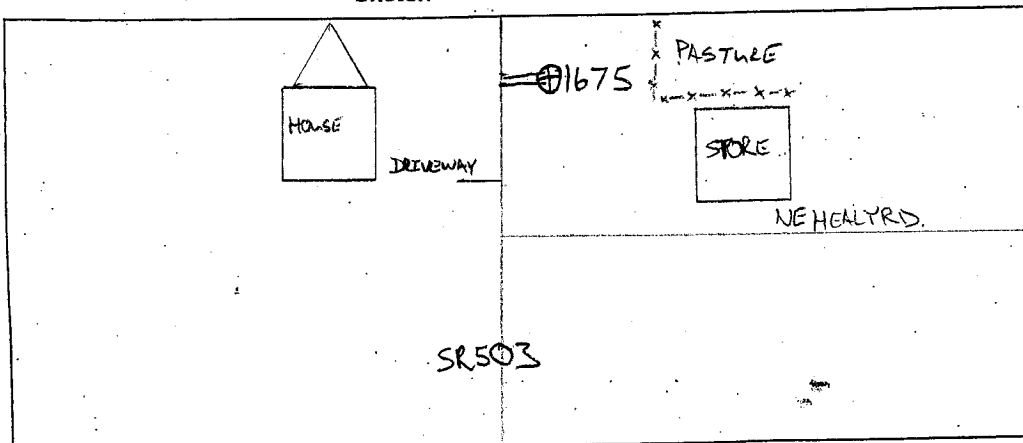

RT

Field Person

SR 503 MP 024.81 OFF SYSTEM ID. LEG 2 DIRECTION OF TRAFFIC SOUTHBOUND LANE ALL OF  
 COUNT IDENTIFIER ATR COUNTER NUMBER 321654 DESCRIPTION: ON SR 503 N/O NE HEALY RD

MONDAY	CARS PICKUPS	BUS MED	SINGLE UNITS HVY	4+	SINGLE UNIT %	DOUBLE UNITS 4-	5	6+	DOUBLE UNIT %	5-	TRAINS 6	7+	TRAIN %	TRUCK %	CLASS UNKNOWN	TOTAL VEHICLES
08-06-07																
AM HOURS																
12 - 1	43				13.7									13.7		51
1 - 2	54				6.8				1.7					8.5		59
2 - 3	44				6.0				4.0					10.0		50
3 - 4	41				12.5									12.5		48
4 - 5	40				2.4									2.4		41
5 - 6	49				7.5									7.5		53
6 - 7	37				7.0				4.7					11.6		43
7 - 8	34				5.6									5.6		36
8 - 9	25				3.7									3.7		27
9 - 10	25				3.7				3.7					3.7		27
10 - 11	6													7.4		6
11 - 12	1															1
AM TOTAL	399				7.2				1.4					8.6		442
PM TOTAL	399				7.2				1.4					8.6		442
DAY TOTAL	399				7.2				1.4					8.6		442
-----																
														2-AXLE EQUIVALENT		452

STATE OF WASHINGTON - DEPARTMENT OF TRANSPORTATION  
 TRIP SYSTEM  
 HOURLY TRAFFIC CLASSIFICATION SUMMARY

SR 503 MP 024.81 OFF SYSTEM ID. LEG 2 DIRECTION OF TRAFFIC SOUTHBOUND LANE ALL OF

COUNT IDENTIFIER ATR COUNTER NUMBER 321654 DESCRIPTION: ON SR 503 N/O NE HEALY RD

08-07-07 TUESDAY AM HOURS	CARS PICKUPS	BUS	SINGLE MED	UNITS HVV	4+ SINGLE UNIT %	DOUBLE UNITS 4-5	6+ DOUBLE UNIT %	5- TRAINS 7+	TRAIN %	TRUCK %	CLASS UNKNOWN	TOTAL VEHICLES
12 - 1	3											4
1 - 2	1											1
2 - 3	1											1
3 - 4	4											4
4 - 5	6											13
5 - 6	33											40
6 - 7	43											49
7 - 8	25											32
8 - 9	26											29
9 - 10	27											32
10 - 11	34											44
11 - 12	33											37
PM HOURS												
12 - 1	34											45
1 - 2	37											47
2 - 3	27											32
3 - 4	43											49
4 - 5	33											42
5 - 6	44											46
6 - 7	33											39
7 - 8	27											30
8 - 9	27											32
9 - 10	19											20
10 - 11	7											7
11 - 12	4											4
AM TOTAL	236											286
PM TOTAL	335											393
DAY TOTAL	571											679
-----												
										14.1	12	700
2-AXLE EQUIVALENT												

STATE OF WASHINGTON - DEPARTMENT OF TRANSPORTATION  
 TRIP SYSTEM  
 HOURLY TRAFFIC CLASSIFICATION SUMMARY

SR 503	MP 024.81	OFF SYSTEM ID.	LEG 2	DIRECTION OF TRAFFIC	COUNTY	LANE ALL OF					
COUNT IDENTIFIER	ATR	COUNTER NUMBER	321654	DESCRIPTION: ON SR 503 N/O NE HEALY RD							
08-08-07											
WEDNESDAY											
AM HOURS	CARS PICKUPS	BUS MED	SINGLE UNITS 4+	SINGLE UNIT %	DOUBLE UNITS 4-5-6+	DOUBLE UNIT %	5-6 TRAINS 7+	TRAIN %	TRUCK %	CLASS UNKNOWN	TOTAL VEHICLES
12 - 1	3		1	100.0					100.0	1	3
1 - 2	2										1
2 - 3	4		1	20.0					20.0		2
3 - 4	9		2	16.7					16.7		5
4 - 5	30		9	23.1					23.1	1	12
5 - 6	40		4	8.9		1			11.1		39
6 - 7	29		4	16.7					16.7		45
7 - 8	27		5	22.9					22.9	1	36
8 - 9	22		3	14.8					18.5		35
9 - 10	31		2	11.1	1				11.1	1	27
10 - 11	38		3	7.1					7.1	1	36
11 - 12											42
PM HOURS											
12 - 1	40	1	5	16.0					16.0	2	50
1 - 2	42		6	15.4	2				19.2		52
2 - 3	39		3	11.1	1				13.3		52
3 - 4	41		7	14.3	1				16.3		45
4 - 5	39		6	12.5	2				16.7	1	49
5 - 6	55		4	4.3	1				8.2	1	48
6 - 7	41		2	5.6	1				4.3	3	61
7 - 8	32		2	20.0	1				8.3	1	46
8 - 9	19		5	4.2					20.0	1	36
9 - 10	22		1		1				8.3	1	25
10 - 11	10										24
11 - 12	1										10
AM TOTAL	235		34	14.8	1	1			15.5	4	283
PM TOTAL	381	1	41	10.7	9	1			12.7	10	448
DAY TOTAL	616	1	75	12.3	10	1			13.8	14	731
									2-AXLE EQUIVALENT		750

SR 503 MP 024.81 OFF SYSTEM ID. LEG 2 DIRECTION OF TRAFFIC SOUTHBOUND LANE ALL OF  
COUNT IDENTIFIER ATR COUNTER NUMBER 321654 DESCRIPTION: ON SR 503 N/O NE HEALY RD

08-09-07 THURSDAY AM HOURS	CARS PICKUPS	BUS MED	SINGLE UNITS HVV	4+ UNIT %	DOUBLE UNITS 4-5	6+ UNIT %	DOUBLE UNITS 6-7	TRAINS 7+	TRAIN %	TRUCK %	CLASS UNKNOWN	TOTAL VEHICLES
12 - 1	4			100.0						100.0		4
1 - 2	3		1	100.0						100.0		3
2 - 3			1	100.0						100.0		1
3 - 4	8		2	16.7						16.7		12
4 - 5	38		2	15.6						15.6		45
5 - 6	41		3	6.8						6.8		44
6 - 7	28		3	11.8		1				14.7		34
7 - 8	30		7	18.9						18.9		37
8 - 9	32		6	15.8						15.8		38
9 - 10	30		5	15.8						18.4		38
10 - 11	33		4	15.4						15.4		39
11 - 12			2			1						1
PM HOURS												
12 - 1	27		3	12.1		1				15.2	1	33
1 - 2	43		6	14.0						14.0		50
2 - 3	52		6	10.3						10.3		58
3 - 4	37		3	9.5		1				11.9		42
4 - 5	52		5	8.6		1				10.3		58
5 - 6	54		6	9.8		1				11.5		61
6 - 7	34		3	7.7		1				10.3	1	39
7 - 8	44		1	2.2						2.2		45
8 - 9	38		2	4.9		1				7.3		41
9 - 10	33		2	5.6						5.6	1	36
10 - 11	13		2	11.8						11.8	2	17
11 - 12	5										1	6
AM TOTAL	247		39	14.5		1				15.2	4	296
PM TOTAL	432		39	8.6		6				9.9	6	486
DAY TOTAL	679		78	10.9		6				11.9	10	782

2-AXLE EQUIVALENT

SR 503 MP 024.81 OFF SYSTEM ID. LEG 2 DIRECTION OF TRAFFIC SOUTHBOUND LANE ALL OF

COUNT IDENTIFIER ATR COUNTER NUMBER 321654 DESCRIPTION: ON SR 503 N/O NE HEALY RD

08-10-07	FRIDAY	AM HOURS	CARS PICKUPS	BUS MED	SINGLE UNITS HVY	4+	SINGLE UNIT %	DOUBLE UNITS 4-	5	6+	DOUBLE UNIT %	5-	6	7+	TRAIN %	TRUCK %	CLASS UNKNOWN	TOTAL VEHICLES
12 - 1	1	1	1				100.0									100.0		1
1 - 2	2	2	1															1
2 - 3	3	3	3															3
3 - 4	4	4	7															10
4 - 5	5	5	7															10
5 - 6	6	6	30															36
6 - 7	7	7																
7 - 8	8	8																
8 - 9	9	9																
9 - 10	10	10																
10 - 11	11	11																
11 - 12	12	12																
12 - 1	1	1																
1 - 2	2	2																
2 - 3	3	3																
3 - 4	4	4																
4 - 5	5	5																
5 - 6	6	6																
6 - 7	7	7																
7 - 8	8	8																
8 - 9	9	9																
9 - 10	10	10																
10 - 11	11	11																
11 - 12	12	12																
AM TOTAL			42		10		19.2											52
PM TOTAL																		
DAY TOTAL			42		10		19.2											52

19.2  
2-AXLE EQUIVALENT 52

08-06-07 THRU 08-10-07

AVERAGE WEEKDAY CLASSIFICATION VOLUMES \*\*\*\*\*

AVERAGE WEEKDAY VOLUME	CARS PICKUPS	BUS MED	SINGLE UNITS HVY	4+	SINGLE UNIT %	DOUBLE UNITS 4-	5	6+	DOUBLE UNIT %	5-	6	7+	TRAIN %	TRUCK %	CLASS UNKNOWN	TOTAL VEHICLES
622	1	74	12	4+	11.9	8	2	1	1.5							731
TOTAL HOURS FOR COUNT 90																
3 DAYS																
AVG WEEKDAY VOL 731 X SEASONAL ADJ. FACTOR 0.7500 = ESTIMATED AVG DAILY TRAFFIC 548																
AMD 2-AXLE EQUIVALENT 13.4																

TRIPS SYSTEM  
HOURLY TRAFFIC CLASSIFICATION SUMMARY

SR 503 MP 024.81 OFF SYSTEM ID. LEG 2 DIRECTION OF TRAFFIC NORTHBOUND LANE ALL OF

COUNT IDENTIFIER ATR COUNTER NUMBER 321675 DESCRIPTION: ON SR 503 N/O NE HEALY RD

08-06-07	CARS PICKUPS	BUS MED	SINGLE UNITS 4+	SINGLE UNIT %	DOUBLE UNITS 4-5	DOUBLE UNITS 6+	DOUBLE UNIT %	5-6 TRAINS	7+ TRAINS	TRAIN %	TRUCK %	CLASS UNKNOWN	TOTAL VEHICLES
MONDAY													
AM HOURS													
1 - 1	42			10.6							10.6		47
2 - 2	61	4	1	10.1	1		1.4				11.6		69
3 - 3	42	6		8.5	1		2.1				10.6		47
4 - 4	51	3		3.7	1		1.9				5.6		54
5 - 5	49	2		14.0	1						14.0		57
6 - 6	65	6	1	10.7	2		2.7				13.3		75
7 - 7	59	7	1	11.8							13.2		68
8 - 8	33	8		13.2							13.2		38
9 - 9	23	5	1	13.2							13.2		23
10 - 10	10	4											12
11 - 11	10	2		16.7							16.7	1	9
12 - 12	8												
AM TOTAL	476	47	4	10.1	6		1.1				11.2	1	537
PM TOTAL	476	47	4	10.1	6		1.1				11.2	1	537
DAY TOTAL	476	47	4	10.1	6		1.1				11.2	1	537
											2-AXLE EQUIVALENT		548



STATE OF WASHINGTON - DEPARTMENT OF TRANSPORTATION  
 TRIP SYSTEM  
 HOURLY TRAFFIC CLASSIFICATION SUMMARY

SR 503 MP 024.81 OFF SYSTEM ID. LEG 2 DIRECTION OF TRAFFIC NORTHBOUND LANE ALL OF  
 COUNT IDENTIFIER ATR COUNTER NUMBER 321675 DESCRIPTION: ON SR 503 N/O NE HEALY RD

08-07-07 TUESDAY AM HOURS	CARS PICKUPS	BUS	SINGLE MED	UNITS HVY	4+ SINGLE UNIT %	DOUBLE UNITS 4-5	6+ DOUBLE UNITS 6+	DOUBLE UNITS UNIT %	5- TRAINS	6 7+	TRAIN %	TRUCK %	CLASS UNKNOWN	TOTAL VEHICLES	
12 - 1	4													5	
1 - 2	1													1	
2 - 3	3													1	
3 - 4	4													1	
4 - 5	3	1			50.0									6	
5 - 6	4													4	
6 - 7	14		4		26.3									19	
7 - 8	17			1	5.3									19	
8 - 9	28		5		17.6									34	
9 - 10	31		4	1	13.5									37	
10 - 11	18		4		20.0									25	
11 - 12	35		3	1	11.4	2	1	4.0		1	2.3			44	
PM HOURS															
12 - 1	35		5	2	16.3								1	43	
1 - 2	27		3	2	20.6									34	
2 - 3	44		3	1	8.3									48	
3 - 4	42		5	1	13.7	1		3.9						51	
4 - 5	51		6		11.9		1	1.7						59	
5 - 6	63		4		6.0									67	
6 - 7	39		7		15.2									46	
7 - 8	43		3		6.5									46	
8 - 9	27		1		3.6									28	
9 - 10	19		2		9.5									21	
10 - 11	11		1		8.3									12	
11 - 12	9													9	
AM TOTAL	156	1	20	5	15.4	2	1	1.5		1	.5		5	195	
PM TOTAL	410		40	7	10.8	1	2	.6					1	464	
DAY TOTAL	566	1	60	12	12.1	3	1	.9		1	.2		6	659	
														2-AXLE EQUIVALENT	683

DOT-RNB505A-B

STATE OF WASHINGTON - DEPARTMENT OF TRANSPORTATION  
 TRIP SYSTEM  
 HOURLY TRAFFIC CLASSIFICATION SUMMARY

DATE 10/09/07  
 TIME 13:47:24  
 PAGE 387

SR 503 MP 024.81 OFF SYSTEM ID. LEG 2 DIRECTION OF TRAFFIC NORTHBOUND LANE ALL OF  
 COUNT IDENTIFIER ATR COUNTER NUMBER 321675 DESCRIPTION: ON SR 503 N/O NE HEALY RD

DATE	TIME	CARS PICKUPS	BUS MED	SINGLE UNITS HVY	4+	SINGLE UNIT %	DOUBLE UNITS 4-	5	6+	DOUBLE UNIT %	5-	6	7+	TRAIN %	TRUCK %	CLASS UNKNOWN	TOTAL VEHICLES
08-08-07	12 - 1	4															4
WEDNESDAY	1 - 2	2															2
AM HOURS	2 - 3	1															1
	3 - 4	2															2
	4 - 5	1															1
	5 - 6	3															3
	6 - 7	9															9
	7 - 8	18															18
	8 - 9	30															30
	9 - 10	35															35
	10 - 11	23															23
	11 - 12	33															33
PM HOURS	12 - 1																
	1 - 2	38															38
	2 - 3	39															39
	3 - 4	42															42
	4 - 5	41															41
	5 - 6	51															51
	6 - 7	64															64
	7 - 8	63															63
	8 - 9	43															43
	9 - 10	31															31
	10 - 11	26															26
	11 - 12	17															17
	AM TOTAL	161															161
	PM TOTAL	460															460
DAY TOTAL		621	2	78	13	6	13.5	5		.7				14.1	10	735	

2-AXLE EQUIVALENT

STATE OF WASHINGTON - DEPARTMENT OF TRANSPORTATION  
 TRIP SYSTEM  
 HOURLY TRAFFIC CLASSIFICATION SUMMARY

SR 503	MP 024.81	OFF SYSTEM ID.	COUNTER NUMBER	321675	DESCRIPTION: ON SR 503 N/O NE HEALY RD	LEG 2	DIRECTION OF TRAFFIC	NORTHBOUND	LANE ALL OF				
COUNT IDENTIFIER	ATR												
08-09-07 THURSDAY	CARS PICKUPS	SINGLE BUS MED	UNITS HVY	4+	SINGLE UNIT %	DOUBLE 4-5	DOUBLE 6+	DOUBLE 5-6	TRAINS 7+	TRAIN %	TRUCK %	CLASS UNKNOWN	TOTAL VEHICLES
12 - 1	4												4
1 - 2	3												3
2 - 3	4												4
3 - 4	5												5
4 - 5	6												6
5 - 6	7												7
6 - 7	8												8
7 - 8	9												9
8 - 9	10												10
9 - 10	11												11
10 - 11	12												12
11 - 12	1												1
PM HOURS	60												60
12 - 1	48	6	1	1	10.4	2	1	3.6	10.4		14.3	3	56
1 - 2	50	5	1	1	10.7				15		14.3	3	55
2 - 3	45	4	1	1	9.1				4		9.1	1	46
3 - 4	67	12		1	2.2		1	1.2	17.3		7.2		81
4 - 5	77	12			16.0				13.0		7.2		83
5 - 6	60	9			6.0		1	1.2	13.0		7.2		69
6 - 7	54	5			13.0				5.3		5.3		57
7 - 8	33	3			5.3				5.7		5.7		35
8 - 9	27	3			5.7				3.6		3.6		28
9 - 10	15	3			3.6				16.7		16.7		18
10 - 11	11	1			16.7				8.3		8.3		12
11 - 12	184	15	8	1	11.2	3	1	1.9	13.0		13.0	3	215
AM TOTAL	547	52	4	1	9.2	3	1	.7	9.9		9.9	3	607
PM TOTAL	731	67	12	1	9.7	6	2	1.0	10.7		10.7	3	822
DAY TOTAL									2-AXLE EQUIVALENT				838

STATE OF WASHINGTON - DEPARTMENT OF TRANSPORTATION  
TRIP SYSTEM  
HOURLY TRAFFIC CLASSIFICATION SUMMARY

SR 503 MP 024.81 OFF SYSTEM ID. LEG 2 DIRECTION OF TRAFFIC NORTHBOUND LANE ALL OF

COUNT IDENTIFIER ATR COUNTER NUMBER 321675 DESCRIPTION: ON SR 503 N/O NE HEALY RD

08-10-07	CARS PICKUPS	BUS MED HVY	SINGLE UNITS 4+	DOUBLE UNITS 4-5	DOUBLE UNITS 6+	DOUBLE UNITS 6+	5-6	TRAINS 7+	TRAIN %	TRUCK %	CLASS UNKNOWN	TOTAL VEHICLES
FRIDAY	1											1
AM HOURS	1											1
12 - 1												
1 - 2												
2 - 3	1											1
3 - 4	1											1
4 - 5	4											4
5 - 6	4											4
6 - 7	17											17
7 - 8			4		1					20.0		25
8 - 9											4	4
9 - 10												
10 - 11												
11 - 12												
PM HOURS												
12 - 1												
1 - 2												
2 - 3												
3 - 4												
4 - 5												
5 - 6												
6 - 7												
7 - 8												
8 - 9												
9 - 10												
10 - 11												
11 - 12												
AM TOTAL	28		4		1					2.7		37
PM TOTAL												
DAY TOTAL	28		4		1					2.7		37

08-06-07 THRU 08-10-07

AVERAGE WEEKDAY CLASSIFICATION VOLUMES \*\*\*\*\*

CARS PICKUPS	BUS MED HVY	SINGLE UNITS 4+	DOUBLE UNITS 4-5	DOUBLE UNITS 6+	DOUBLE UNITS 6+	5-6	TRAINS 7+	TRAIN %	TRUCK %	CLASS UNKNOWN	TOTAL VEHICLES
639	1	68	12	5	11.6	5	1	1	.9		739
TOTAL HOURS FOR COUNT 91											6
3 DAYS											758
AVG WEEKDAY VOL 739 X SEASONAL ADJ. FACTOR 0.7500 = ESTIMATED AVG DAILY TRAFFIC											554
AND 2-AXLE EQUIVALENT											

SR 503 MP 024.81 OFF SYSTEM ID. LEG 2 DIRECTION OF TRAFFIC BOTH WAYS LANE ALL OF

COUNT IDENTIFIER ATR COUNTER NUMBER 321675 DESCRIPTION: ON SR 503 N/O NE HEALY RD

08-06-07 MONDAY AM HOURS	CARS PICKUPS	SINGLE MED	UNITS HVY	4+ UNIT	SINGLE %	DOUBLE 4-5	UNITS 6+	DOUBLE UNIT	5- %	TRAINS 6	7+ %	TRAIN %	TRUCK %	CLASS UNKNOWN	TOTAL VEHICLES
12 - 1	85	9	2	1	12.2	2		1.6					12.2	1	98
1 - 2	115	9	2	1	8.6	2		3.1					10.2	1	128
2 - 3	86	5	1	2	7.2	3		1.0					10.3	1	97
3 - 4	92	7	1	1	7.8	1		1.6					8.8	1	102
4 - 5	89	7	1	1	9.2	2		2.7					9.2	1	98
5 - 6	114	11	1	1	9.4	2		1.6					10.9	1	128
6 - 7	96	10	1	1	9.9	2		2.7					12.6	1	111
7 - 8	67	7	1	1	9.5	1		2.0					9.5	1	74
8 - 9	58	5	1	1	9.2	1		2.0					4.0	1	65
9 - 10	48	2	1	1	2.0	1		2.0					11.1	1	50
10 - 11	16				11.1										18
11 - 12	9														10
AM TOTAL	875	73	9	4	8.8	12		1.2					10.0	6	979
PM TOTAL	875	73	9	4	8.8	12		1.2					10.0	6	979
DAY TOTAL	875	73	9	4	8.8	12		1.2					10.0	6	979
-----															
														2-AXLE EQUIVALENT	1000

SR 503 MP 024.81 OFF SYSTEM ID. LEG 2 DIRECTION OF TRAFFIC BOTH WAYS LANE ALL OF  
 COUNT IDENTIFIER ATR COUNTER NUMBER 321675 DESCRIPTION: ON SR 503 N/O NE HEALY RD

08-07-07 TUESDAY AM HOURS	CARS PICKUPS	BUS	SINGLE MED	UNITS HVV	4+	SINGLE UNIT %	DOUBLE UNITS			5-	TRAINS 6	7+	TRAIN %	TRUCK %	CLASS UNKNOWN	TOTAL VEHICLES		
							4-	5	6+									
11 - 1	7															9		
12 - 2	2															2		
1 - 3	2															4		
2 - 4	4															4		
3 - 5	9															19		
4 - 6	37															44		
5 - 7	57															68		
6 - 8	42															51		
7 - 9	54															63		
8 - 10	58															69		
9 - 11	52															69		
10 - 12	68															81		
PM HOURS																		
12 - 1	69															88		
1 - 2	64															81		
2 - 3	71															80		
3 - 4	85															100		
4 - 5	84															101		
5 - 6	107															113		
6 - 7	72															85		
7 - 8	70															76		
8 - 9	54															60		
9 - 10	38															41		
10 - 11	18															19		
11 - 12	13															13		
AM TOTAL	392															481		
PM TOTAL	745															857		
DAY TOTAL	1137															1338		
															.1	13.7	18	1383
															2-AXLE EQUIVALENT			

SR 503 MP 024.81 OFF SYSTEM ID. LEG 2 DIRECTION OF TRAFFIC BOTH WAYS LANE ALL OF  
 COUNT IDENTIFIER ATR COUNTER NUMBER 321675 DESCRIPTION: ON SR 503 N/O NE HEALY RD

08-08-07 WEDNESDAY AM HOURS	CARS PICKUPS	BUS	SINGLE MED	UNITS HVY	4+ UNIT %	DOUBLE 4-5	UNITS 6+	DOUBLE UNIT %	5- 6	TRAINS 7+	TRAIN %	TRUCK %	CLASS UNKNWN	TOTAL VEHICLES
12 - 1	7		1		33.3							33.3		7
1 - 2	2											14.3		3
2 - 3	3											38.9		7
3 - 4	6		1		14.3							21.4	1	18
4 - 5	10		4		38.9							14.0		42
5 - 6	33		9	3	21.4							14.0		57
6 - 7	49		7		12.3			1				14.0		57
7 - 8	47		4		14.0							14.3	2	70
8 - 9	57		6	3	14.3							14.9	3	67
9 - 10	57		5	2	11.9	2						16.7	1	66
10 - 11	54		5	5	16.7							13.3	1	66
11 - 12	71	1	9	5	13.3							18.4	2	83
PM HOURS														
12 - 1	78		13	3	18.4	3						18.0	1	98
1 - 2	81		11	3	15.0	2						11.7	2	100
2 - 3	81		5	4	9.6	2						19.6	1	94
3 - 4	82		17	1	17.6	2						15.7	1	102
4 - 5	90		15		13.9	2						11.8	1	108
5 - 6	119		15	6	11.0	1						5.2	6	135
6 - 7	104		7		5.2	2						8.4	1	116
7 - 8	75		5	9	6.0	1						15.0	1	83
8 - 9	50		9	9	15.0							11.1	1	60
9 - 10	48		5		9.3	1						12.5	1	54
10 - 11	27													27
11 - 12	6		1		12.5								1	8
AM TOTAL	396	2	51	16	15.2	2	1					15.8	8	480
PM TOTAL	841	1	102	11	11.8	13	1					13.1	16	986
DAY TOTAL	1237	3	153	27	12.9	15	1					14.0	24	1466
-----														
2-AXLE EQUIVALENT 1502														

SR 503 MP 024.81 OFF SYSTEM ID. LEG 2 DIRECTION OF TRAFFIC BOTH WAYS LANE ALL OF  
 COUNT IDENTIFIER ATR COUNTER NUMBER 321675 DESCRIPTION: ON SR 503 N/O NE HEALY RD

08-09-07 THURSDAY AM HOURS	CARS PICKUPS	BUS	SINGLE MED	UNITS HVY	4+	SINGLE UNIT %	DOUBLE UNITS 4-	5	6+	DOUBLE UNIT %	5-	TRAINS 6	7+	TRAIN %	TRUCK %	CLASS UNKNWN	TOTAL VEHICLES
12 - 1	8		1			25.0									25.0		8
1 - 2	3																4
2 - 3	3																3
3 - 4	1		1			50.0									50.0		2
4 - 5	10		2		3	29.4									29.4		17
5 - 6	41		7			14.3									14.3		49
6 - 7	52		7			11.9									11.9		59
7 - 8	45		5		1	12.3			2						17.5		57
8 - 9	54		10			15.4									16.9		65
9 - 10	69		7		1	10.3									10.3		78
10 - 11	71		7			13.1									14.3		84
11 - 12	74		7		3	11.8			1						12.9		85
PM HOURS																	
12 - 1	87		9		2	11.0									12.0	1	100
1 - 2	91		11		2	12.3									14.2		106
2 - 3	102		10		1	9.7									9.7		113
3 - 4	82		4		1	5.7									6.8		88
4 - 5	119		17		1	12.9									14.4		139
5 - 6	131		11			7.6			1						9.0		144
6 - 7	94		12			11.1									12.0	1	108
7 - 8	98		4			3.9									3.9		102
8 - 9	71		4			5.3									6.6		76
9 - 10	60		3			4.7									4.7		64
10 - 11	28		5			14.3									14.3	2	35
11 - 12	16		1			5.6									5.6	1	18
AM TOTAL	431		54		11	13.1									14.3	7	511
PM TOTAL	979		91		7	9.0									9.9	6	1093
DAY TOTAL	1410		145		18	10.3									11.3	13	1604
-----																	
2-AXLE EQUIVALENT																	
1634																	



SR 503 MP 024.81 OFF SYSTEM ID. LEG 2 DIRECTION OF TRAFFIC BOTH WAYS LANE ALL OF  
COUNT IDENTIFIER ATR COUNTER NUMBER 321675 DESCRIPTION: ON SR 503 N/O NE HEALY RD

08-10-07 FRIDAY AM HOURS	CARS PICKUPS	BUS MED	SINGLE UNITS 4+	DOUBLE UNITS 4-5	6+	DOUBLE UNITS 6+	TRAINS 7+	TRAIN %	TRUCK %	CLASS UNKNOWN	TOTAL VEHICLES
12 - 1	2		1						100.0		2
1 - 2											1
2 - 3	2										2
3 - 4	4										4
4 - 5	11								21.4		4
5 - 6	34		6						14.6		14
6 - 7						1			2.4		41
7 - 8											
8 - 9											
9 - 10											
10 - 11											
11 - 12											
PM HOURS											
12 - 1											
1 - 2											
2 - 3											
3 - 4											
4 - 5											
5 - 6											
6 - 7											
7 - 8											
8 - 9											
9 - 10											
10 - 11											
11 - 12											
AM TOTAL	53		10			1			15.6		64
PM TOTAL									1.6		17.2
DAY TOTAL	53		10			1			15.6		64
											17.2
											2-AXLE EQUIVALENT
											65

08-06-07 THRU 08-10-07

AVERAGE WEEKDAY CLASSIFICATION VOLUMES	CARS PICKUPS	BUS MED	SINGLE UNITS 4+	DOUBLE UNITS 4-5	6+	DOUBLE UNITS 6+	TRAINS 7+	TRAIN %	TRUCK %	CLASS UNKNOWN	TOTAL VEHICLES
1261		2	142	24	5	11.8	12	3	1	1.1	1469
											18
											1504
											AMD 2-AXLE EQUIVALENT

TOTAL HOURS FOR COUNT 90  
 3 DAYS  
 AVG WEEKDAY VOL 1469 X SEASONAL ADJ. FACTOR 0.7500 = ESTIMATED AVG DAILY TRAFFIC 1102  
 PEAK HOUR PERCENTAGES: K = 9.80 D = 57.64 T = 9.03  
 PEAK HOUR LOCATION : VOLUME = 144 DATE: 08/09/07 TIME: 05:00 PM

09767