



Interval  60 min.  15 min.  
 Binned(CL/SP)  Count(volume)  
Lane No  1  2  
  
Direction Channel 1 \_\_\_\_\_  
Direction Channel 2 \_\_\_\_\_  
Data Hog # 7058

Counter No. 165875 Count ID hpms  
SR 503 RRT/RRQ \_\_\_\_\_ MP 24.81  
Leg 2 Direction SB OSID \_\_\_\_\_

NE

Station Description \_ON SR-503 N/O Healy rd

Date	Day	Time	Comments
4/14/08	2	11:41	Manual (1) <u>1</u> (2) _____ Set up ok JDM 6.4v Counter (1) <u>1</u> (2)
4/15/08	3	09:27	Manual (1) <u>2</u> (2) _____ Check ok JDM 6.4v Counter (1) <u>2</u> (2)
4/16/08	4	11:18	Manual (1) <u>2</u> (2) _____ Check ok JDM 6.6v Counter (1) <u>2</u> (2)
4/17/08	5	08:50	Manual (1) <u>4</u> (2) _____ Check ok JDM 6.8v Counter (1) <u>4</u> (2)
4/18/08	6	07:56	Manual (1) <u>1</u> (2) _____ P/U ok JDM 6.3v Counter (1) <u>1</u> (2)

Sketch

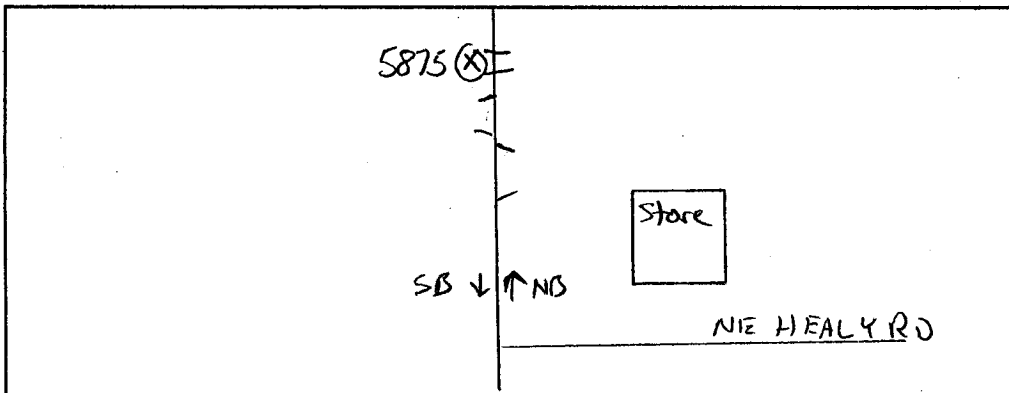

SR-503



North

J. Mydler

Field Person



Interval  60 min.  15 min.  
 Binned(CL/SP)  Count(volume)  
Lane No  1  2

---

Direction Channel 1 \_\_\_\_\_  
Direction Channel 2 \_\_\_\_\_  
Data Hog # 7058

Counter No. 162296 Count ID hpms  
SR 503 RRT/RRQ MP 24.81  
Leg 2 Direction NB OSID \_\_\_\_\_

NE

Station Description \_ON SR-503 N/O Healy rd

Date	Day	Time	Comments			
4/14/08	2	11:40	Manual (1) <u>3</u> (2) _____ Counter (1) <u>3</u> (2)	Set up ok	JDM	6.5v
4/15/08	3	09:27	Manual (1) <u>1</u> (2) _____ Counter (1) <u>1</u> (2)	Check ok	JDM	6.8v
4/16/08	4	11:17	Manual (1) <u>4</u> (2) _____ Counter (1) <u>4</u> (2)	Check ok	JDM	7.1v
4/17/08	5	08:50	Manual (1) <u>1</u> (2) _____ Counter (1) <u>1</u> (2)	Check ok	JDM	6.8v
4/18/08	6	07:55	Manual (1) <u>2</u> (2) _____ Counter (1) <u>2</u> (2)	P/U ok	JDM	6.4

Sketch

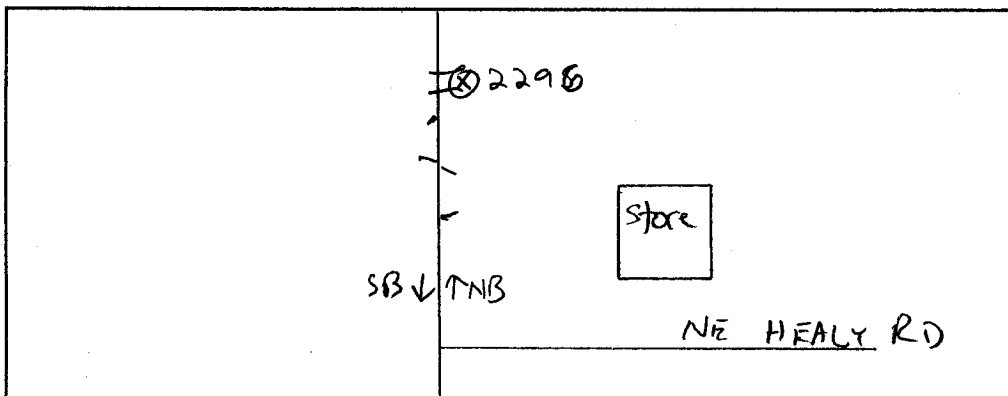

SR-503



Field Person

SR 503 MP 024.81 OFF SYSTEM ID. LEG 2 DIRECTION OF TRAFFIC SOUTHBOUND LANE ALL OF  
 COUNT IDENTIFIER HPMS COUNTER NUMBER 165875 DESCRIPTION: ON SR 503 N/O NE HEALY RD

04-14-08	CARS PICKUPS	SINGLE BUS MED HVY	UNITS 4+	SINGLE UNIT %	DOUBLE UNITS 4- 5 6+	DOUBLE UNIT %	5- TRAINS 6 7+	TRAIN %	TRUCK %	CLASS UNKNOWN	TOTAL VEHICLES
MONDAY	24	1	1	4.0					4.0		25
AM HOURS	30								12.0		30
12 - 1	22								11.1		25
1 - 2	23								15.2	1	27
2 - 3	26					3.7			6.7	2	33
3 - 4	26								10.5		30
4 - 5	17								16.7		19
5 - 6	15										18
6 - 7	12										13
7 - 8	7										7
8 - 9	5										5
9 - 10	1										1
10 - 11											
11 - 12											
PM HOURS											
12 - 1											
1 - 2											
2 - 3											
3 - 4											
4 - 5											
5 - 6											
6 - 7											
7 - 8											
8 - 9											
9 - 10											
10 - 11											
11 - 12											
AM TOTAL	208	16	2	7.7	1	.4			8.2	6	233
PM TOTAL	208	16	2	7.7	1	.4			8.2	6	233
DAY TOTAL	208	16	2	7.7	1	.4			8.2	6	236

2-AXLE EQUIVALENT

COUNT IDENTIFIER HPMS COUNTER NUMBER 165875 DESCRIPTION: ON SR 503 N/O NE HEALY RD

04-15-08	CARS	BUS	SINGLE UNITS	DOUBLE UNITS	DOUBLE UNITS	5-	6	7+	TRAIN	TRUCK	CLASS	TOTAL
TUESDAY	PICKUPS	MED	HVY	4+	4-	5	6+	7+	%	%	UNKNOWN	VEHICLES
AM HOURS												
12 - 1	1											1
1 - 2	1											2
2 - 3	1											1
3 - 4	1											1
4 - 5	16											16
5 - 6	36											38
6 - 7	41											35
7 - 8	32											42
8 - 9	13											33
9 - 10	23											33
10 - 11	21											16
11 - 12	21											16
PM HOURS												24
12 - 1	24											23
1 - 2	24											25
2 - 3	30											25
3 - 4	20											34
4 - 5	25											23
5 - 6	26											33
6 - 7	22											33
7 - 8	14											31
8 - 9	11											24
9 - 10	3											24
10 - 11	2											14
11 - 12	2											13
AM TOTAL	219											231
PM TOTAL	203											233
DAY TOTAL	422											464

2-AXLE EQUIVALENT 6.7 11 464

STATE OF WASHINGTON - DEPARTMENT OF TRANSPORTATION  
 TRIP SYSTEM  
 HOURLY TRAFFIC CLASSIFICATION SUMMARY

SR 503	MP 024.81	OFF SYSTEM ID.	LEG 2	DIRECTION OF TRAFFIC	SOUTHBOUND	LANE ALL OF								
COUNT IDENTIFIER	HPMS	COUNTER NUMBER	165875	DESCRIPTION: ON SR 503 N/O NE HEALY RD										
04-16-08	WEDNESDAY	CARS PICKUPS	BUS MED	SINGLE UNITS 4+	SINGLE UNIT %	DOUBLE UNITS 4-5	DOUBLE UNITS 6+	DOUBLE UNIT %	5- TRAINS 6	7+ TRAIN %	TRUCK %	CLASS UNKNOWN	TOTAL VEHICLES	
12 - 1	1	1			50.0						50.0		2	
1 - 2	4												4	
2 - 3	15												15	
3 - 4	32				11.1						11.1		36	
4 - 5	32				3.0						3.0		33	
5 - 6	42				4.5						4.5		44	
6 - 7	23				20.0						23.3		30	
7 - 8	23				11.5						11.5		26	
8 - 9	24				11.1						11.1		27	
9 - 10	28				6.1						6.1		33	
10 - 11	33				2.8						2.8		36	
11 - 12	22				11.5						11.5		26	
1 - 2	31				3.0						3.0		33	
2 - 3	28				12.1						12.1		33	
3 - 4	28				9.7						9.7		31	
4 - 5	19				8.0						8.0		21	
5 - 6	16				17.6						17.6		25	
6 - 7	13												17	
7 - 8	10												17	
8 - 9	3												10	
9 - 10	2												3	
10 - 11													3	
11 - 12													2	
AM TOTAL	224				8.8						.8		1	250
PM TOTAL	228				7.5						.4		6	254
DAY TOTAL	452				8.1						.6		7	504
													2-AXLE EQUIVALENT	512



SR 503 MP 024.81 OFF SYSTEM ID. LEG 2 DIRECTION OF TRAFFIC SOUTHBOUND LANE ALL OF  
 COUNT IDENTIFIER HPMS COUNTER NUMBER 165875 DESCRIPTION: ON SR 503 N/O NE HEALY RD

04-18-08	CARS PICKUPS	BUS MED	SINGLE UNITS HVY	4+	SINGLE UNIT %	DOUBLE UNITS 4-	5	6+	DOUBLE UNIT %	5-	6	7+	TRAIN %	TRUCK %	CLASS UNKNOWN	TOTAL VEHICLES
FRIDAY AM HOURS	1	1	1	33.3										33.3	2	2
1 - 2	2	2												16.7	1	3
2 - 3	5	5												16.7	2	6
3 - 4	14	14												7.7	1	14
4 - 5	35	35												5.9	1	39
5 - 6	32		3		7.7				2.9							34
6 - 7			1		2.9				2.9							
7 - 8																
8 - 9																
9 - 10																
10 - 11																
11 - 12																
12 - 1																
1 - 2																
2 - 3																
3 - 4																
4 - 5																
5 - 6																
6 - 7																
7 - 8																
8 - 9																
9 - 10																
10 - 11																
11 - 12																
AM TOTAL	89	5	5.0	2	2.0									7.0	4	100
PM TOTAL	89	5	5.0	2	2.0									7.0	4	100
DAY TOTAL	89	5	5.0	2	2.0									7.0	4	100

04-14-08 THRU 04-18-08

AVERAGE WEEKDAY CLASSIFICATION VOLUMES \*\*\*\*\*  
 CARS PICKUPS | BUS MED HVY 4+ | SINGLE UNIT % | DOUBLE UNITS 4- 5 6+ | DOUBLE UNIT % | 5- 6 7+ | TRAIN % | TRUCK % | CLASS UNKNOWN | TOTAL VEHICLES  
 446 | 35 2 2 1 | 7.4 | 2 | 1 | .6 | | | 8.0 11 | 498  
 TOTAL HOURS FOR COUNT 91  
 3 DAYS | FACTOR GROUP GR-10  
 AVG WEEKDAY VOL 498 X SEASONAL ADJ. FACTOR 1.1200 = ESTIMATED AVG DAILY TRAFFIC 558  
 AMD 2-AXLE EQUIVALENT

SR 503 MP 024.81 OFF SYSTEM ID. LEG 2 DIRECTION OF TRAFFIC NORTHBOUND LANE ALL OF  
 COUNT IDENTIFIER HPMS COUNTER NUMBER 162296 DESCRIPTION: ON SR 503 N/O NE HEALY RD

04-14-08	CARS PICKUPS	SINGLE BUS MED HVY	SINGLE UNITS 4+	SINGLE UNIT %	DOUBLE UNITS 4-5	DOUBLE UNITS 6+	DOUBLE UNIT %	5-6 TRAINS	7+ TRAIN	TRAIN %	TRUCK %	CLASS UNKNOWN	TOTAL VEHICLES
MONDAY													
AM HOURS													
12 - 1	32	1		3.0							3.0	1	33
1 - 2	22	3		11.5		1	3.8				15.4		26
2 - 3	30	2		6.3							6.3		32
3 - 4	36	5		11.9							11.9	1	42
4 - 5	35	3		7.3	1		2.4				9.8	2	41
5 - 6	63	5		7.2							7.2	1	69
6 - 7	34	1		2.9							2.9		35
7 - 8	32	1		3.0							3.0	1	33
8 - 9	20	3		12.5							12.5	1	24
9 - 10	14												14
10 - 11	8	1		10.0							10.0	1	10
11 - 12	7												7
AM TOTAL	333	25		6.8	1	1	.5				7.4	6	366
PM TOTAL	333	25		6.8	1	1	.5				7.4	6	366
DAY TOTAL	333	25		6.8	1	1	.5				7.4	6	366

2-AXLE EQUIVALENT 369







STATE OF WASHINGTON - DEPARTMENT OF TRANSPORTATION  
 TRIP SYSTEM  
 HOURLY TRAFFIC CLASSIFICATION SUMMARY

SR 503	COUNT IDENTIFIER	HPMS	OFF SYSTEM ID.	COUNTER NUMBER	LEG 2	DESCRIPTION: ON SR 503 N/O NE HEALY RD	DIRECTION OF TRAFFIC	LANE ALL OF												
								SINGLE UNIT %	DOUBLE UNITS 4-5	DOUBLE UNITS 6+	DOUBLE UNIT %	5- TRAINS 6	7+	TRAIN %	TRUCK %	CLASS UNKNOWN	TOTAL VEHICLES			
04-17-08	THURSDAY	CARS PICKUPS																		
12 -	1	5																		5
1 -	2																			4
2 -	3																			4
3 -	4																			4
4 -	5																			4
5 -	6																			4
6 -	7																			4
7 -	8																			4
8 -	9																			4
9 -	10																			4
10 -	11																			4
11 -	12																			4
PM HOURS																				
12 -	1	23																		27
1 -	2	29																		31
2 -	3	21																		22
3 -	4	35																		40
4 -	5	33																		40
5 -	6	45																		51
6 -	7	53																		59
7 -	8	34																		43
8 -	9	25																		29
9 -	10	30																		33
10 -	11	23																		23
11 -	12	14																		15
AM TOTAL		122																		146
PM TOTAL		348																		393
DAY TOTAL		470																		539
-----																				
																				15
																				15
																				547

2-AXLE EQUIVALENT

STATE OF WASHINGTON - DEPARTMENT OF TRANSPORTATION  
TRIP SYSTEM  
HOURLY TRAFFIC CLASSIFICATION SUMMARY

SR 503 MP 024.81 OFF SYSTEM ID. LEG 2 DIRECTION OF TRAFFIC NORTHBOUND LANE ALL OF

COUNT IDENTIFIER HPMS COUNTER NUMBER 162296 DESCRIPTION: ON SR 503 N/O NE HEALY RD

04-18-08	CARS PICKUPS	SINGLE MED	HVY	4+	SINGLE UNIT %	DOUBLE 4-5	6+	DOUBLE UNIT %	5-6	7+	TRAIN %	TRUCK %	CLASS UNKNOWN	TOTAL VEHICLES
FRIDAY AM HOURS	5	2			28.6							28.6		7
12 - 1	1													1
1 - 2														1
2 - 3														1
3 - 4														3
4 - 5														6
5 - 6														7
6 - 7														11
7 - 8														
8 - 9														
9 - 10														
10 - 11														
11 - 12														
PM HOURS	1													1
12 - 1														
1 - 2														
2 - 3														
3 - 4														
4 - 5														
5 - 6														
6 - 7														
7 - 8														
8 - 9														
9 - 10														
10 - 11														
11 - 12														
AM TOTAL	23				17.2							17.2	1	29
PM TOTAL														1
DAY TOTAL	23		5		17.2							17.2	1	29

2-AXLE EQUIVALENT

04-14-08 THRU 04-18-08

AVERAGE WEEKDAY CLASSIFICATION VOLUMES	CARS PICKUPS	SINGLE MED	HVY	4+	SINGLE UNIT %	DOUBLE 4-5	6+	DOUBLE UNIT %	5-6	7+	TRAIN %	TRUCK %	CLASS UNKNOWN	TOTAL VEHICLES
AVG WEEKDAY VOLUME	444		50	2	1	10.4	2	.4	1			11.0	10	510
AMD 2-AXLE EQUIVALENT														

TOTAL HOURS FOR COUNT 91  
3 DAYS  
AVG WEEKDAY VOL 510 X SEASONAL ADJ. FACTOR 1.1200 = ESTIMATED AVG DAILY TRAFFIC 571

SR 503	MP 024.81	OFF SYSTEM ID.	LEG 2	DIRECTION OF TRAFFIC	BOTH WAYS	LANE ALL OF					
COUNT IDENTIFIER	HPMS	COUNTER NUMBER	162296	DESCRIPTION: ON SR 503 N/O NE HEALY RD							
04-14-08											
MONDAY											
AM HOURS	CARS PICKUPS	SINGLE BUS MED HVY	4+	SINGLE UNIT %	DOUBLE UNITS 4-5-6+	DOUBLE UNIT %	5-6 TRAINS 7+	TRAIN %	TRUCK %	CLASS UNKNOWN	TOTAL VEHICLES
12 - 1	1										
1 - 2	2										
2 - 3	3										
3 - 4	4										
4 - 5	5										
5 - 6	6										
6 - 7	7										
7 - 8	8										
8 - 9	9										
9 - 10	10										
10 - 11	11										
11 - 12	12										
PM HOURS											
12 - 1	56	2		3.4					3.4		58
1 - 2	52	3		5.4					7.1		56
2 - 3	52	4		8.8					8.8		57
3 - 4	59	7	1	10.1					11.6		69
4 - 5	61	8		10.8	1				12.2		74
5 - 6	89	7		7.1		1			7.1		99
6 - 7	51	3		5.6					5.6		54
7 - 8	47	3		7.8					7.8		51
8 - 9	32	3	1	8.1					8.1		37
9 - 10	21										21
10 - 11	13	1		6.7					6.7		15
11 - 12	8										8
AM TOTAL	541	41	2	7.2	1	2	.5		7.7	12	599
PM TOTAL	541	41	2	7.2	1	2	.5		7.7	12	599
DAY TOTAL	541	41	2	7.2	1	2	.5		7.7	12	599
									2-AXLE EQUIVALENT		604

STATE OF WASHINGTON - DEPARTMENT OF TRANSPORTATION  
 TRIP SYSTEM  
 HOURLY TRAFFIC CLASSIFICATION SUMMARY

SR 503	MP 024.81	OFF SYSTEM ID.	LEG 2	DIRECTION OF TRAFFIC	BOTH WAYS	LANE ALL OF					
COUNT IDENTIFIER	HPMS	COUNTER NUMBER	162296	DESCRIPTION: ON SR 503 N/O NE HEALY RD							
04-15-08											
TUESDAY											
AM HOURS	CARS PICKUPS	BUS MED	SINGLE UNIT %	DOUBLE UNITS 4-5	DOUBLE UNITS 6+	DOUBLE UNIT %	5-6 TRAINS 7+	TRAIN %	TRUCK %	CLASS UNKNOWN	TOTAL VEHICLES
12 -	4	1	20.0						20.0		5
1 -	2		33.3						33.3		2
2 -	2	1									3
3 -	3										2
4 -	4										1
5 -	5		5.3						5.3		19
6 -	6		4.7						4.7		43
7 -	7		6.4						6.4		47
8 -	8		8.5						8.5		59
9 -	9		10.0						10.0		50
10 -	10		13.8						13.8		29
11 -	11		2.6	1		2.6			2.6		38
12 -	12		6.8						6.8		44
PM HOURS											
1 -	49	3	5.8						5.8	1	52
2 -	46	4	7.8						7.8		51
3 -	50	8	13.8						13.8	1	58
4 -	56	8	12.3						12.3	1	65
5 -	73	11	12.8						12.8	2	86
6 -	82	7	8.1						8.1	2	99
7 -	63	7	9.6						9.6	3	73
8 -	41										41
9 -	33										35
10 -	9										35
11 -	12										16
12 -	12										12
11 -	8	1	11.1						11.1		9
AM TOTAL	310	23	7.6	1		.3			7.9	3	340
PM TOTAL	525	49	8.4						8.4	22	597
DAY TOTAL	835	72	8.1	1		.1			8.2	25	937
									2-AXLE EQUIVALENT		940

STATE OF WASHINGTON - DEPARTMENT OF TRANSPORTATION  
 TRIP SYSTEM  
 HOURLY TRAFFIC CLASSIFICATION SUMMARY

SR 503	MP 024.81	OFF SYSTEM ID.	LEG 2	DIRECTION OF TRAFFIC	BOTH WAYS	LANE ALL	OF									
COUNT IDENTIFIER	HPMS	COUNTER NUMBER	162296	DESCRIPTION: ON SR 503 N/O NE HEALY RD												
04-16-08	WEDNESDAY	CARS PICKUPS	BUS	SINGLE MED	UNITS HVY	4+	SINGLE UNIT %	DOUBLE UNITS 4-5	6+	DOUBLE UNIT %	5-6	TRAINS 7+	TRAIN %	TRUCK %	CLASS UNKNOWN	TOTAL VEHICLES
12 - 1	4			1			33.3							33.3		4
1 - 2	2						14.3							5.3		3
2 - 3	6						14.3							5.3		5
3 - 4	5						5.3							13.2		19
4 - 5	18						13.2							7.0		38
5 - 6	33						7.0							14.8		43
6 - 7	40						11.5							23.1	1	61
7 - 8	51						12.5							13.0		52
8 - 9	35						13.0							12.5		40
9 - 10	40						8.8							12.3		46
10 - 11	49						8.0							13.0	1	57
11 - 12	67						9.3							11.3	2	75
12 - 1	47						11.3							12.0	1	54
1 - 2	54						9.9							8.0	1	62
2 - 3	72						8.0							9.9	1	83
3 - 4	73						3.6							11.0	1	81
4 - 5	69						4.0							11.6	1	75
5 - 6	65						15.4							13	1	73
6 - 7	52						25.0							8	1	55
7 - 8	37						13.3							9.9	1	43
8 - 9	24						9.9							11.2	1	25
9 - 10	11						11.2							1037	8	25
10 - 11	6						10.5							1037	8	13
11 - 12	6						10.5							1037	8	13
AM TOTAL	323						12.0							13.3	2	375
PM TOTAL	577						9.6							9.9	6	647
DAY TOTAL	900						10.5							11.2	8	1022

2-AXLE EQUIVALENT

SR 503	MP 024.81	OFF SYSTEM ID.	LEG 2	DIRECTION OF TRAFFIC	BOTH WAYS	LANE ALL OF									
COUNT IDENTIFIER	HPMS	COUNTER NUMBER	1622296	DESCRIPTION: ON SR 503 N/O NE HEALY RD											
04-17-08															
THURSDAY															
AM HOURS	CARS PICKUPS	BUS	SINGLE UNITS	4+	SINGLE UNIT %	DOUBLE UNITS	4-5-6+	DOUBLE UNIT %	5-6	TRAINS	7+	TRAIN %	TRUCK %	CLASS UNKNOWN	TOTAL VEHICLES
12 - 1	5														5
1 - 2	2		1		50.0								50.0		2
2 - 3	1														2
3 - 4	2		1		5.6								5.6		18
4 - 5	17		3		7.1								7.1		42
5 - 6	38		5		9.7								9.7		62
6 - 7	54		5	1	8.6								8.6		58
7 - 8	53		5		8.6								8.6		58
8 - 9	49		4		8.6	2							12.1		51
9 - 10	44		4	1	9.8	1							11.8		51
10 - 11	47		4		7.7								9.6		52
11 - 12	44		5	1	13.0	1							13.0		54
PM HOURS															
12 - 1	53		3		5.3								5.3		57
1 - 2	47		3		5.9								5.9		51
2 - 3	59		5		7.1	2							11.4		70
3 - 4	56		10		14.5	1							15.9		69
4 - 5	72		11		12.9								14.1		85
5 - 6	91		3		3.0		1						4.0		100
6 - 7	62		5		7.0								7.0		71
7 - 8	36		4		9.8								9.8		41
8 - 9	45		5		9.8								9.8		51
9 - 10	30		2		9.5	1							3.2		31
10 - 11	18		2		9.5								9.5		21
11 - 12	10		1		9.1								9.1		11
AM TOTAL	356		32	3	9.1	3	1		1.0				10.1		9
PM TOTAL	579		52		7.9	4	2		.9	1			9.0		20
DAY TOTAL	935		84	3	8.4	7	3		.9	1		.1	9.4	29	1064
													2-AXLE EQUIVALENT		1081



SR 503 MP 024.81 OFF SYSTEM ID. LEG 2 DIRECTION OF TRAFFIC BOTH WAYS LANE ALL OF  
COUNT IDENTIFIER HPMS COUNTER NUMBER 162296 DESCRIPTION: ON SR 503 N/O NE HEALY RD

04-18-08 FRIDAY AM HOURS	CARS PICKUPS	BUS MED	SINGLE HVT	4+ HVT	SINGLE UNIT %	DOUBLE UNITS	DOUBLE UNIT %	5- 6+	TRAINS 7+	TRAIN %	TRUCK %	CLASS UNKNOWN	TOTAL VEHICLES
12 - 1	5	2	1		22.2		25.0				25.0	2	4
1 - 2	2	1										1	4
2 - 3	2												2
3 - 4	6								1		14.3		7
4 - 5	17												17
5 - 6	41												45
6 - 7	39								1				45
7 - 8													
8 - 9													
9 - 10													
10 - 11													
11 - 12													
AM TOTAL	112		10		7.8				2		1.6	5	129
PM TOTAL													
DAY TOTAL	112		10		7.8				2		1.6	5	129

04-14-08 THRU 04-18-08

AVERAGE WEEKDAY CLASSIFICATION VOLUMES \*\*\*\*\*  
 CARS PICKUPS | BUS MED HVT | SINGLE UNIT % | DOUBLE UNITS | DOUBLE UNIT % | 5-6 | TRAINS 7+ | TRAIN % | TRUCK % | CLASS UNKNOWN | TOTAL VEHICLES  
 890 85 5 1 9.0 4 1 .5 1 .1 9.6 21 1008

TOTAL HOURS FOR COUNT 91  
 3 DAYS 1008 X SEASONAL ADJ. FACTOR 1.1200 = ESTIMATED AVG DAILY TRAFFIC 1129

PEAK HOUR PERCENTAGES: K = 9.92 D = 59.00 T = 4.00  
 PEAK HOUR LOCATION : VOLUME = 100 DATE: 04/17/08 TIME: 05:00 PM

Note: Med Low SB