

GK Traffic Counter

Interval 60 Min. 15 Min.
 2 Tube Classification
 Lane No. 1 2

1 Channel Tube A+B
 2 Channel Tube A, B
 Direction Channel A EB
 Direction Channel B WB
 Module No. 14863

Counter No. 708 Count ID H1905
 SR 501 RRT _____ MP 0.61
 Leg Z Direction See A,B OSID _____

Station Description - ON SR501 W/O Franklin Street

Date	Day	Time	Comments
10/27/03	2	1406	Manual A <u>2</u> B <u>2</u> Counter A <u>2</u> B <u>2</u> Set out. JM/DB 6.3
10/28	3	1352	Manual A <u>34</u> B <u>23</u> Counter A <u>34</u> B <u>23</u> CHECK OK 6.20
10/29	4	0751	Manual A <u>34</u> B <u>21</u> Counter A <u>34</u> B <u>21</u> CHECK OK 6.4
10/31	6	1046	Manual A <u>1</u> B <u>1</u> Counter A <u>1</u> B <u>1</u> PU/OK 6.2
			Manual A _____ B _____ Counter A _____ B _____

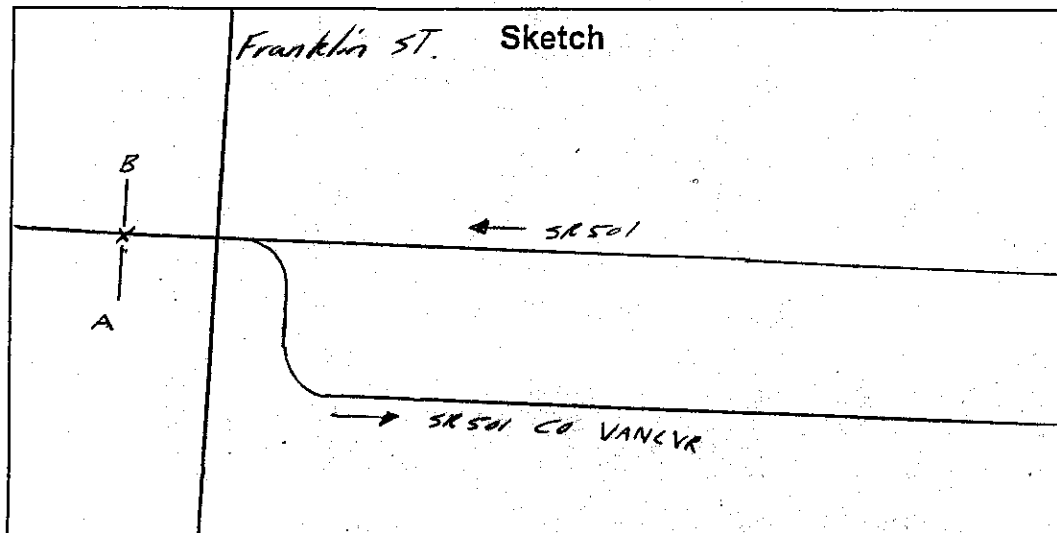

J. Mills / D. Blake
 Field Person

SR 501 MP 000.61 OFF SYSTEM ID. LEG 2 DIRECTION OF TRAFFIC WESTBOUND LANE ALL OF
COUNT IDENTIFIER HPMS COUNTER NUMBER 000708 DESCRIPTION: ON SR 501 W/O FRANKLIN ST

10/27/03 MONDAY	AM HOURS												PM HOURS												DAILY TOTAL								
	1	2	3	4	5	6	7	8	9	10	11	12	1	2	3	4	5	6	7	8	9	10	11	12									
00-15																																	
15-30	12	1	2	3	4	5	6	7	8	9	10	11	12	1	2	3	4	5	6	7	8	9	10	11									
30-45	1	2	3	4	5	6	7	8	9	10	11	12	1	2	3	4	5	6	7	8	9	10	11	12									
45-00																																	
HOUR	315												305												286	277	133	88	85	87	46	49	1671
TOT	315												305												286	277	133	88	85	87	46	49	1671

AM PEAK HOUR 0000 TO 0000 VOLUME 0
PM PEAK HOUR 0215 TO 0315 VOLUME 404

10/28/03 TUESDAY	AM HOURS												PM HOURS												DAILY TOTAL														
	1	2	3	4	5	6	7	8	9	10	11	12	1	2	3	4	5	6	7	8	9	10	11	12															
00-15																																							
15-30	12	1	2	3	4	5	6	7	8	9	10	11	12	1	2	3	4	5	6	7	8	9	10	11															
30-45	1	2	3	4	5	6	7	8	9	10	11	12	1	2	3	4	5	6	7	8	9	10	11	12															
45-00																																							
HOUR	319												306												321	286	400	379	341	323	301	252	144	106	99	93	62	33	4708
TOT	319												306												321	286	400	379	341	323	301	252	144	106	99	93	62	33	4708

AM PEAK HOUR 0630 TO 0730 VOLUME 393
PM PEAK HOUR 1200 TO 0100 VOLUME 400

10/29/03 WEDNESDAY	AM HOURS												PM HOURS												DAILY TOTAL														
	1	2	3	4	5	6	7	8	9	10	11	12	1	2	3	4	5	6	7	8	9	10	11	12															
00-15																																							
15-30	12	1	2	3	4	5	6	7	8	9	10	11	12	1	2	3	4	5	6	7	8	9	10	11															
30-45	1	2	3	4	5	6	7	8	9	10	11	12	1	2	3	4	5	6	7	8	9	10	11	12															
45-00																																							
HOUR	266												313												288	317	372	388	356	340	299	247	160	76	104	85	68	43	4649
TOT	266												313												288	317	372	388	356	340	299	247	160	76	104	85	68	43	4649

AM PEAK HOUR 0700 TO 0800 VOLUME 367
PM PEAK HOUR 1245 TO 0145 VOLUME 398

TRIP SYSTEM
15 MINUTE TRAFFIC COUNT SUMMARY

SR 501 MP 000.61 OFF SYSTEM ID. LEG 2 DIRECTION OF TRAFFIC WESTBOUND LANE ALL OF

COUNT IDENTIFIER HPMS COUNTER NUMBER 000708 DESCRIPTION: ON SR 501 W/O FRANKLIN ST

10/30/03 THURSDAY		AM HOURS												PM HOURS					DAILY TOTAL							
COUNT	IDENTIFIER	1	2	3	4	5	6	7	8	9	10	11	12	1	2	3	4	5	6	7	8	9	10	11	12	TOTAL
12	1	1	2	3	4	5	6	7	8	9	10	11	12	1	2	3	4	5	6	7	8	9	10	11	12	1506
12	2	2	3	4	5	6	7	8	9	10	11	12	1	2	3	4	5	6	7	8	9	10	11	12	1506	
12	3	3	4	5	6	7	8	9	10	11	12	1	2	3	4	5	6	7	8	9	10	11	12	1506		
12	4	4	5	6	7	8	9	10	11	12	1	2	3	4	5	6	7	8	9	10	11	12	1506			
12	5	5	6	7	8	9	10	11	12	1	2	3	4	5	6	7	8	9	10	11	12	1506				
12	6	6	7	8	9	10	11	12	1	2	3	4	5	6	7	8	9	10	11	12	1506					
12	7	7	8	9	10	11	12	1	2	3	4	5	6	7	8	9	10	11	12	1506						
12	8	8	9	10	11	12	1	2	3	4	5	6	7	8	9	10	11	12	1506							
12	9	9	10	11	12	1	2	3	4	5	6	7	8	9	10	11	12	1506								
12	10	10	11	12	1	2	3	4	5	6	7	8	9	10	11	12	1506									
12	11	11	12	1	2	3	4	5	6	7	8	9	10	11	12	1506										
12	12	12	1	2	3	4	5	6	7	8	9	10	11	12	1506											
TOT	24	16	10	18	63	124	335	340	329	283	325	348	392	357	388	328	263	257	176	145	89	91	61	32	4794	

AM PEAK HOUR 0630 TO 0730 VOLUME 380
PM PEAK HOUR 1215 TO 0115 VOLUME 396

AM TOTAL 2215
PM TOTAL 2579

10/31/03 FRIDAY		AM HOURS												PM HOURS					DAILY TOTAL							
COUNT	IDENTIFIER	1	2	3	4	5	6	7	8	9	10	11	12	1	2	3	4	5	6	7	8	9	10	11	12	TOTAL
12	1	1	2	3	4	5	6	7	8	9	10	11	12	1	2	3	4	5	6	7	8	9	10	11	12	1506
12	2	2	3	4	5	6	7	8	9	10	11	12	1	2	3	4	5	6	7	8	9	10	11	12	1506	
12	3	3	4	5	6	7	8	9	10	11	12	1	2	3	4	5	6	7	8	9	10	11	12	1506		
12	4	4	5	6	7	8	9	10	11	12	1	2	3	4	5	6	7	8	9	10	11	12	1506			
12	5	5	6	7	8	9	10	11	12	1	2	3	4	5	6	7	8	9	10	11	12	1506				
12	6	6	7	8	9	10	11	12	1	2	3	4	5	6	7	8	9	10	11	12	1506					
12	7	7	8	9	10	11	12	1	2	3	4	5	6	7	8	9	10	11	12	1506						
12	8	8	9	10	11	12	1	2	3	4	5	6	7	8	9	10	11	12	1506							
12	9	9	10	11	12	1	2	3	4	5	6	7	8	9	10	11	12	1506								
12	10	10	11	12	1	2	3	4	5	6	7	8	9	10	11	12	1506									
12	11	11	12	1	2	3	4	5	6	7	8	9	10	11	12	1506										
12	12	12	1	2	3	4	5	6	7	8	9	10	11	12	1506											
TOT	30	25	19	20	42	107	271	316	263	294	119														1506	

AM PEAK HOUR 0715 TO 0815 VOLUME 340
PM PEAK HOUR 0000 TO 0000 VOLUME 0

AM TOTAL 1506
PM TOTAL 0

10/27/03 THRU 10/31/03
TOTAL HOURS FOR COUNT 91

3 DAYS AVG WEEKDAY VOL 4717 X SEASONAL ADJ. FACTOR 0.9400 = 4434 X AXLE CORR FACTOR 0.9454 = ESTIMATED AVG DAILY TRAFFIC 4192

FACTOR GROUP GR-02

FACTOR GROUP A380

TRIP SYSTEM
15 MINUTE TRAFFIC COUNT SUMMARY

SR 501 MP 000.61 OFF SYSTEM ID. LEG 2 DIRECTION OF TRAFFIC EASTBOUND LANE ALL OF
COUNT IDENTIFIER HPMS COUNTER NUMBER 000708 DESCRIPTION: ON SR 501 W/O FRANKLIN ST

10/27/03 MONDAY		AM HOURS												PM HOURS												DAILY TOTAL	
TIME	COUNT	1	2	3	4	5	6	7	8	9	10	11	12	1	2	3	4	5	6	7	8	9	10	11	12	TOT	TOT
00-15	12	1	2	3	4	5	6	7	8	9	10	11	12	1	2	3	4	5	6	7	8	9	10	11	12	121	18
15-30	1	2	3	4	5	6	7	8	9	10	11	12	1	2	3	4	5	6	7	8	9	10	11	12	105	6	
30-45																										113	5
45-00																										96	12
HOUR																											
TOT																										314	2178

AM PEAK HOUR 0000 TO 0000 VOLUME 0
PM PEAK HOUR 0415 TO 0515 VOLUME 541

AM TOTAL 0
PM TOTAL 2178

10/28/03 TUESDAY		AM HOURS												PM HOURS												DAILY TOTAL	
TIME	COUNT	1	2	3	4	5	6	7	8	9	10	11	12 <th>1</th> <th>2</th> <th>3</th> <th>4</th> <th>5</th> <th>6</th> <th>7</th> <th>8</th> <th>9</th> <th>10</th> <th>11</th> <th>12 <th>TOT</th> <th>TOT</th> </th>	1	2	3	4	5	6	7	8	9	10	11	12 <th>TOT</th> <th>TOT</th>	TOT	TOT
00-15	11	2	3	4	5	6	7	8	9	10	11	12	1	2	3	4	5	6	7	8	9	10	11	12	95	18	
15-30	5	3	4	5	6	7	8	9	10	11	12	1	2	3	4	5	6	7	8	9	10	11	12	105	5		
30-45	2	3	4	5	6	7	8	9	10	11	12	1	2	3	4	5	6	7	8	9	10	11	12	77	10		
45-00	6	7	8	9	10	11	12	1	2	3	4	5	6	7	8	9	10	11	12	99	4						
HOUR																											
TOT	24	26	34	25	50	102	277	435	376	357	419	441	430	463	405	433	522	434	208	118	73	66	56	37	5811		

AM PEAK HOUR 1045 TO 1145 VOLUME 441
PM PEAK HOUR 0430 TO 0530 VOLUME 525

AM TOTAL 2566
PM TOTAL 3245

10/29/03 WEDNESDAY		AM HOURS												PM HOURS												DAILY TOTAL	
TIME	COUNT	1	2	3	4	5	6	7	8	9	10	11	12 <th>1</th> <th>2</th> <th>3</th> <th>4</th> <th>5</th> <th>6</th> <th>7</th> <th>8</th> <th>9</th> <th>10</th> <th>11</th> <th>12 <th>TOT</th> <th>TOT</th> </th>	1	2	3	4	5	6	7	8	9	10	11	12 <th>TOT</th> <th>TOT</th>	TOT	TOT
00-15	7	6	2	3	4	5	6	7	8	9	10	11	12	1	2	3	4	5	6	7	8	9	10	11	12	60	11
15-30	5	6	2	3	4	5	6	7	8	9	10	11	12	1	2	3	4	5	6	7	8	9	10	11	12	43	14
30-45	11	12	2	3	4	5	6	7	8	9	10	11	12	1	2	3	4	5	6	7	8	9	10	11	12	80	6
45-00	5	4	3	4	5	6	7	8	9	10	11	12	1	2	3	4	5	6	7	8	9	10	11	12	119	7	
HOUR																											
TOT	28	28	9	34	36	112	293	475	384	360	349	462	446	394	366	451	482	444	199	94	98	65	78	38	5725		

AM PEAK HOUR 0715 TO 0815 VOLUME 476
PM PEAK HOUR 0430 TO 0530 VOLUME 541

AM TOTAL 2570
PM TOTAL 3155

SR 501 MP 000.61 OFF SYSTEM ID. LEG 2 DIRECTION OF TRAFFIC EASTBOUND LANE ALL OF

COUNT IDENTIFIER HPMS COUNTER NUMBER 000708 DESCRIPTION: ON SR 501 W/O FRANKLIN ST

10/30/03 THURSDAY		AM HOURS												PM HOURS												DAILY TOTAL
12	1	2	3	4	5	6	7	8	9	10	11	12	1	2	3	4	5	6	7	8	9	10	11	12	TOTAL	
12	1	2	3	4	5	6	7	8	9	10	11	12	1	2	3	4	5	6	7	8	9	10	11	12	1762	
00-15	8	5	7	4	8	22	47	80	119	72	80	96	139	95	113	113	156	170	70	35	32	24	16	10	10	
15-30	2	9	2	1	14	29	67	126	84	92	82	99	139	104	96	113	84	139	46	25	31	11	16	9		
30-45	3	7	2	4	19	28	69	114	105	65	85	104	100	99	151	132	99	44	36	19	10	29	8	8		
45-00	5	4	3	6	10	35	83	153	113	97	111	110	90	97	106	123	102	78	31	29	10	17	10	10		
TOT	18	25	19	15	51	114	266	473	421	326	358	409	468	395	410	500	474	486	191	125	92	62	71	37	5806	
									AM PEAK HOUR 0715 TO 0815 VOLUME							512									AM TOTAL 2495	
									PM PEAK HOUR 0430 TO 0530 VOLUME							543										PM TOTAL 3311

10/31/03 FRIDAY		AM HOURS												PM HOURS												DAILY TOTAL
12	1	2	3	4	5	6	7	8	9	10	11	12	1	2	3	4	5	6	7	8	9	10	11	12	TOTAL	
12	1	2	3	4	5	6	7	8	9	10	11	12	1	2	3	4	5	6	7	8	9	10	11	12	1762	
00-15	12	11	7	7	12	20	39	91	84	78	102														1762	
15-30	8	4	7	8	9	40	51	84	89	60	77													402		
30-45	8	5	4	11	7	26	62	122	89	85														0		
45-00	4	15	4	4	16	36	76	105	90	93														0		
TOT	32	35	22	30	44	122	228	402	352	316	179													1762		
									AM PEAK HOUR 0700 TO 0800 VOLUME							402									AM TOTAL 1762	
									PM PEAK HOUR 0000 TO 0000 VOLUME							0									PM TOTAL 0	

10/27/03 THRU 10/31/03 TOTAL HOURS FOR COUNT 91

3 DAYS AVG WEEKDAY VOL 5781 X SEASONAL ADJ. FACTOR 0.9400 = 5434 X AXLE CORR FACTOR 0.9454 = ESTIMATED AVG DAILY TRAFFIC 5137

FACTOR GROUP GR-02

FACTOR GROUP A380

TRIP SYSTEM
15 MINUTE TRAFFIC COUNT SUMMARY

SR 501 MP 000.61 OFF SYSTEM ID. LEG 2 DIRECTION OF TRAFFIC BOTH WAYS LANE ALL OF

COUNT IDENTIFIER HPMS COUNTER NUMBER 000708 DESCRIPTION: ON SR 501 W/O FRANKLIN ST

10/27/03 MONDAY		AM HOURS												PM HOURS												DAILY TOTAL	
TIME	COUNT	1	2	3	4	5	6	7	8	9	10	11	12	1	2	3	4	5	6	7	8	9	10	11	12	TOTAL	TOTAL
00-15	12	1	2	3	4	5	6	7	8	9	10	11	12	1	2	3	4	5	6	7	8	9	10	11	12	199	30
15-30	11	2	3	4	5	6	7	8	9	10	11	12	1	2	3	4	5	6	7	8	9	10	11	12	184	21	
30-45	16	15	2	23	11	170	245	172	169	153	197	161	195	206	210	207	215	192	91	42	54	26	44	31	241	21	
45-00	10	8	5	19	30	83	204	175	168	154	195	220	195	166	174	169	101	62	52	57	41	28	11	11	189	24	
TOT	51	47	16	64	79	238	605	842	650	673	637	779	818	782	722	791	781	691	359	170	202	150	146	81	629	3849	

AM PEAK HOUR 0000 TO 0000 VOLUME 0
PM PEAK HOUR 0415 TO 0515 VOLUME 844

10/28/03 TUESDAY		AM HOURS												PM HOURS												DAILY TOTAL	
TIME	COUNT	1	2	3	4	5	6	7	8	9	10	11	12 <th>1</th> <th>2</th> <th>3</th> <th>4</th> <th>5</th> <th>6</th> <th>7</th> <th>8</th> <th>9</th> <th>10</th> <th>11</th> <th>12 <th>TOTAL</th> <th>TOTAL</th> </th>	1	2	3	4	5	6	7	8	9	10	11	12 <th>TOTAL</th> <th>TOTAL</th>	TOTAL	TOTAL
00-15	19	5	10	8	17	27	91	175	178	159	185	177	219	202	195	186	240	223	89	65	39	43	33	31	186	31	
15-30	12	8	10	8	17	63	110	200	186	188	188	178	202	218	178	207	186	190	82	59	49	37	37	13	156	13	
30-45	8	21	6	11	40	47	214	221	156	173	172	196	188	225	179	194	209	155	105	63	41	39	26	14	175	26	
45-00	14	10	23	21	24	92	192	192	175	143	195	176	221	197	194	169	188	118	76	37	43	40	22	12	169	12	
TOT	53	44	49	48	98	229	607	788	695	663	740	727	830	842	746	756	823	686	352	224	172	159	118	70	695	10519	

AM PEAK HOUR 0715 TO 0815 VOLUME 791
PM PEAK HOUR 1245 TO 0145 VOLUME 866

10/29/03 WEDNESDAY		AM HOURS												PM HOURS												DAILY TOTAL	
TIME	COUNT	1	2	3	4	5	6	7	8	9	10	11	12 <th>1</th> <th>2</th> <th>3</th> <th>4</th> <th>5</th> <th>6</th> <th>7</th> <th>8</th> <th>9</th> <th>10</th> <th>11</th> <th>12 <th>TOTAL</th> <th>TOTAL</th> </th>	1	2	3	4	5	6	7	8	9	10	11	12 <th>TOTAL</th> <th>TOTAL</th>	TOTAL	TOTAL
00-15	14	14	3	11	20	29	105	168	168	170	167	187	208	198	182	207	190	264	121	52	55	52	49	26	168	26	
15-30	11	10	6	11	18	69	126	199	135	166	163	200	229	194	168	200	215	192	91	42	54	26	44	31	172	31	
30-45	16	15	2	23	11	57	170	245	172	169	153	197	161	195	206	210	207	134	85	24	36	31	25	13	175	13	
45-00	10	8	5	19	30	83	204	230	175	168	154	195	220	195	166	174	169	101	62	52	57	41	28	11	174	11	
TOT	51	47	16	64	79	238	605	842	650	673	637	779	818	782	722	791	781	691	359	170	202	150	146	81	650	10374	

AM PEAK HOUR 0700 TO 0800 VOLUME 842
PM PEAK HOUR 0415 TO 0515 VOLUME 855

SR 501 MP 000.61 OFF SYSTEM ID. LEG 2 DIRECTION OF TRAFFIC BOTH WAYS LANE ALL OF

COUNT IDENTIFIER HPMS COUNTER NUMBER 000708 DESCRIPTION: ON SR 501 W/O FRANKLIN ST

10/30/03 THURSDAY		AM HOURS												PM HOURS												DAILY TOTAL
COUNT	IDENTIFIER	1	2	3	4	5	6	7	8	9	10	11	12	1	2	3	4	5	6	7	8	9	10	11	12	
12	1	2	3	4	5	6	7	8	9	10	11	12	1	2	3	4	5	6	7	8	9	10	11	12	10600	
42	41	29	33	114	238	601	813	750	609	683	757	860	752	798	828	737	743	367	270	181	153	132	69			
		AM PEAK HOUR 0715 TO 0815 VOLUME 866												PM PEAK HOUR 1200 TO 0100 VOLUME 860												AM TOTAL 4770
																										PM TOTAL 5890

10/31/03 FRIDAY		AM HOURS												PM HOURS												DAILY TOTAL
COUNT	IDENTIFIER	1	2	3	4	5	6	7	8	9	10	11	12	1	2	3	4	5	6	7	8	9	10	11	12	
12	1	2	3	4	5	6	7	8	9	10	11	12	1	2	3	4	5	6	7	8	9	10	11	12	3268	
62	60	41	50	86	229	499	718	615	610	298																
		AM PEAK HOUR 0715 TO 0815 VOLUME 735												PM PEAK HOUR 0000 TO 0000 VOLUME 0												AM TOTAL 3268
																										PM TOTAL 0

10/27/03 THRU 10/31/03 TOTAL HOURS FOR COUNT 91

3 DAYS AVG WEEKDAY VOL 10498 X SEASONAL ADJ. FACTOR 0.9400 = 9868 X AXLE CORR FACTOR 0.9454 = ESTIMATED AVG DAILY TRAFFIC 9329

PEAK HOUR PERCENTAGES: K = 8.26 D = 56.29

PEAK HOUR LOCATION : VOLUME = 867 DATE: 10/30/03 TIME: 11:45 AM