



Interval  60 min.  15 min.  
 Binned(CL/SP)  Count(volume)  
Lane No  1  2  
  
Direction Channel 1 \_\_\_\_\_  
Direction Channel 2 \_\_\_\_\_  
Data Hog # 7060

Counter No. 162286 Count ID HPMS  
SR 500 RRT/RRQ \_\_\_\_\_ MP 17.26  
Leg 1 Direction SB OSID \_\_\_\_\_

Station Description SE ON SR 500 N/O Leadbetter Rd

Date	Day	Time	Comments
4/14/08	2	12:32	Manual (1) <u>2</u> (2) _____ Counter (1) <u>2</u> (2) _____ set cntr ok bj 6.5
4/15	3	09:21	Manual (1) <u>6</u> (2) _____ Counter (1) <u>6</u> (2) _____ chk cntr ok bj 6.4
4/16	4	13:03	Manual (1) <u>10</u> (2) _____ Counter (1) <u>10</u> (2) _____ chk cntr ok bj 6.4
4/17	5	08:51	Manual (1) <u>12</u> (2) _____ Counter (1) <u>12</u> (2) _____ chk cntr ok bj 6.4
4/18	6	0835	Manual (1) <u>1</u> (2) _____ Counter (1) <u>1</u> (2) _____ P.U. cntr <del>at</del> bj 6.8

Sketch

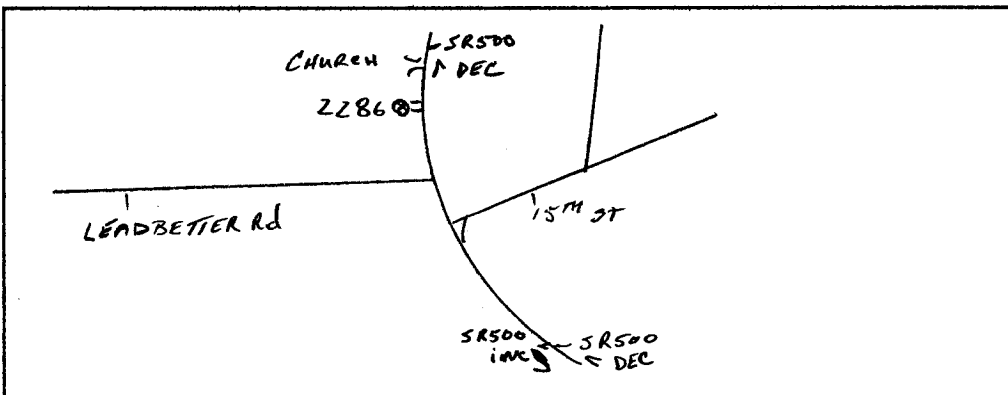

*B. JOHNSON*  
Field Person



Interval  60 min.  15 min.  
 Binned(CL/SP)  Count(volume)  
 Lane No  1  2  
 Direction Channel 1 \_\_\_\_\_  
 Direction Channel 2 \_\_\_\_\_  
 Data Hog # 7060

Counter No. 168697 Count ID HPMS  
 SR 500 RRT/RRQ \_\_\_\_\_ MP 17.26  
 Leg 1 Direction NB OSID \_\_\_\_\_

Station Description SE ON SR 500 N/O Leadbetter Rd

Date	Day	Time	Comments
4/14/08	2	12:37	Manual (1) <u>2</u> (2) _____ Counter (1) <u>2</u> (2) _____ set cntr ok bj 6.4
4/15	3	09:27	Manual (1) <u>8</u> (2) _____ Counter (1) <u>8</u> (2) _____ chk cntr ok bj 6.5
4/16	4	13:08	Manual (1) <u>12</u> (2) _____ Counter (1) <u>12</u> (2) _____ chk cntr ok bj 6.7
4/17	5	08:57	Manual (1) <u>9</u> (2) _____ Counter (1) <u>9</u> (2) _____ chk cntr ok bj 6.4
4/18	6	0837	Manual (1) <u>1</u> (2) _____ Counter (1) <u>1</u> (2) _____ P.U. cntr ok bj 6.3

Sketch

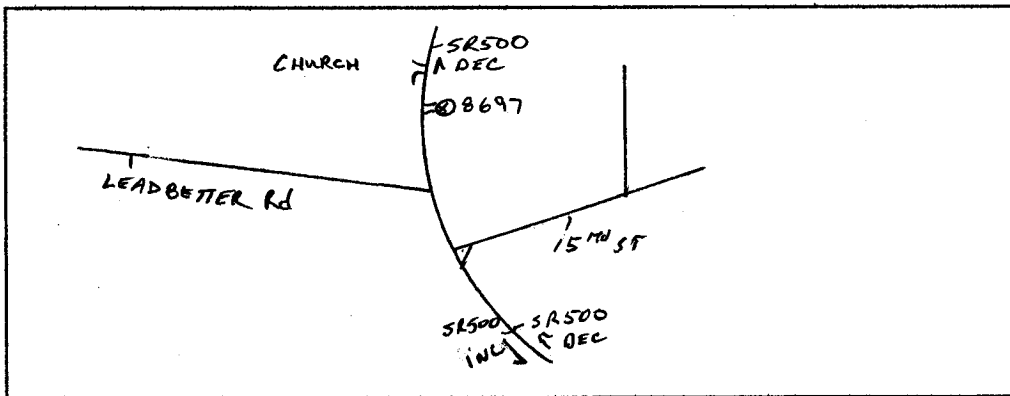

*B. JOHNSON*  
Field Person

STATE OF WASHINGTON - DEPARTMENT OF TRANSPORTATION  
 TRIP SYSTEM  
 HOURLY TRAFFIC CLASSIFICATION SUMMARY

SR 500	MP 017.26	OFF SYSTEM ID.	LEG 1	DIRECTION OF TRAFFIC	SOUTHBOUND	LANE ALL OF							
COUNT IDENTIFIER	HPMS	COUNTER NUMBER	162286	DESCRIPTION: ON SR 500 N/O SE LEADBETTER RD									
04-14-08													
MONDAY													
AM HOURS	CARS PICKUPS	BUS	SINGLE MED	SINGLE UNIT %	DOUBLE UNITS 4+	DOUBLE UNITS 5+	DOUBLE UNITS 6+	DOUBLE UNITS 7+	TRAINS 8+	TRAIN %	TRUCK %	CLASS UNKNOWN	TOTAL VEHICLES
12 - 1	1												
1 - 2	2												
2 - 3	3												
3 - 4	4												
4 - 5	5												
5 - 6	6												
6 - 7	7												
7 - 8	8												
8 - 9	9												
9 - 10	10												
10 - 11	11												
11 - 12	12												
PM HOURS													
12 - 1	1												
1 - 2	2												
2 - 3	3												
3 - 4	4												
4 - 5	5												
5 - 6	6												
6 - 7	7												
7 - 8	8												
8 - 9	9												
9 - 10	10												
10 - 11	11												
11 - 12	12												
AM TOTAL	828	6	27	3	4.1	1	2	.3			4.5	4	871
PM TOTAL	828	6	27	3	4.1	1	2	.3			4.5	4	871
DAY TOTAL	828	6	27	3	4.1	1	2	.3			4.5	4	871

2-AXLE EQUIVALENT

SR 500 MP 017.26 OFF SYSTEM ID. LEG 1 DIRECTION OF TRAFFIC SOUTHBOUND LANE ALL OF  
 COUNT IDENTIFIER HPMS COUNTER NUMBER 162286 DESCRIPTION: ON SR 500 N/O SE LEADBETTER RD

04-15-08 TUESDAY AM HOURS	CARS PICKUPS	BUS	SINGLE MED	UNITS HVV	4+	SINGLE UNIT %	DOUBLE 4-	UNITS 5	6+	DOUBLE UNIT %	5-	TRAINS 6	7+	TRAIN %	TRUCK %	CLASS UNKNOWN	TOTAL VEHICLES
12 - 1	5					50.0											5
1 - 2	3					12.5											3
2 - 3	7					7.4											2
3 - 4	25					7.4											8
4 - 5	92					4.2											27
5 - 6	177					6.7											96
6 - 7	201					6.5											193
7 - 8	162					9.4											217
8 - 9	124					6.8											181
9 - 10	97					8.4											146
10 - 11	136					2.9											107
11 - 12	106					10.0											140
PM HOURS																	
12 - 1	101					5.6											120
1 - 2	104					2.7											107
2 - 3	135					5.6											110
3 - 4	134					8.7											143
4 - 5	133					3.6											149
5 - 6	92					2.1											138
6 - 7	57					6.5											94
7 - 8	57					3.4											62
8 - 9	20					4.8											59
9 - 10	18					12.5											21
10 - 11	7					6.1											18
11 - 12	1					6.7											8
AM TOTAL	1030					5.5											1125
PM TOTAL	964					6.1											1029
DAY TOTAL	1994					6.1											2154

2-AXLE EQUIVALENT 21 2165

STATE OF WASHINGTON - DEPARTMENT OF TRANSPORTATION  
 TRIP SYSTEM  
 HOURLY TRAFFIC CLASSIFICATION SUMMARY

SR 500	MP 017.26	OFF SYSTEM ID.	LEG 1	DIRECTION OF TRAFFIC	SOUTHBOUND	LANE ALL OF												
COUNT IDENTIFIER	HPMS	COUNTER NUMBER	162286	DESCRIPTION: ON SR 500 N/O SE LEADBETTER RD														
04-16-08																		
WEDNESDAY	CARS PICKUPS	BUS	SINGLE MED	HVY	4+	SINGLE UNIT %	DOUBLE UNITS 4-	5	6+	DOUBLE UNIT %	5-	TRAINS 6	7+	TRAIN %	TRUCK %	CLASS UNKNOWN	TOTAL VEHICLES	
12 - 1	2																	2
1 - 2	5																	5
2 - 3	2																	2
3 - 4	10																	10
4 - 5	31																	33
5 - 6	81		2			6.1	2			2.4					6.1		85	
6 - 7	191		15			2.4	1			2.4					4.7		207	
7 - 8	172	6	7			7.5				7.5					7.7		186	
8 - 9	174	6	9			8.4				8.4					8.4		190	
9 - 10	124		11			9.4				9.4					9.4		138	
10 - 11	133		9			6.9				6.9					8.3		145	
11 - 12	104		5			4.5	1	2		1.4					5.4		111	
PM HOURS																		
12 - 1	88		3			4.3			1	1.1					5.4		93	
1 - 2	87		8			12.0									12.0		100	
2 - 3	116	3	7			7.9				7.9					7.9		126	
3 - 4	121	6	3			7.6				7.6					7.6		131	
4 - 5	133		3	1		2.9	1			.7					3.6		139	
5 - 6	118		4			3.3									3.3		123	
6 - 7	123		4			3.9									3.9		128	
7 - 8	78		1			1.3				1.3					1.3		79	
8 - 9	75		3			3.8				3.8					3.8		79	
9 - 10	77		5			2.5				2.5					2.5		79	
10 - 11	14		2			6.7				6.7					6.7		15	
11 - 12	5		1														5	
AM TOTAL	1029	12	60	5		6.9	4	2		.5					7.5		2	1114
PM TOTAL	1035	12	41	3		5.1	1	1		.2					5.3		4	1097
DAY TOTAL	2064	24	101	8		6.0	5	2	1	.4					6.4		6	2211
															2-AXLE EQUIVALENT			2225



SR 500 MP 017.26 OFF SYSTEM ID. LEG 1 DIRECTION OF TRAFFIC SOUTHBOUND LANE ALL OF  
 COUNT IDENTIFIER HPMS COUNTER NUMBER 162286 DESCRIPTION: ON SR 500 N/O SE LEADBETTER RD

04-18-08	CARS PICKUPS	BUS MED	SINGLE UNITS 4+	DOUBLE UNITS 5	6+	DOUBLE UNITS 6+	5- TRAINS 7+	TRAIN %	TRUCK %	CLASS UNKNOWN	TOTAL VEHICLES
FRIDAY AM HOURS	4	3	1	11.1	11.1	11.1	11.1	11.1	11.1	1	4
12 - 1	3	8	3	5.4	12.6	6.6	4.1	11.1	11.1	1	3
1 - 2	3	3	1	11.1	11.1	11.1	11.1	11.1	11.1	1	3
2 - 3	3	3	1	11.1	11.1	11.1	11.1	11.1	11.1	1	3
3 - 4	8	3	1	5.4	12.6	6.6	4.1	11.1	11.1	1	9
4 - 5	24	67	3	5.4	12.6	6.6	4.1	11.1	11.1	1	27
5 - 6	152	22	1	12.6	6.6	4.1	11.1	11.1	11.1	1	74
6 - 7	196	5	8	6.6	4.1	11.1	11.1	11.1	11.1	1	175
7 - 8											212
8 - 9											
9 - 10											
10 - 11											
11 - 12											
AM TOTAL	457	5	37	8.7	4	1	1.0	9.7	1	507	
PM TOTAL	457	5	37	8.7	4	1	1.0	9.7	1	507	
DAY TOTAL	457	5	37	8.7	4	1	1.0	9.7	1	507	

04-14-08 THRU 04-18-08  
 AVERAGE WEEKDAY CLASSIFICATION VOLUMES \*\*\*\*\*  
 CARS PICKUPS | BUS MED HVY 4+ | SINGLE UNIT % | DOUBLE UNITS 5 | 6+ | DOUBLE UNITS 6+ | 5- TRAINS 7+ | TRAIN % | TRUCK % | CLASS UNKNOWN | TOTAL VEHICLES  
 2066 | 19 | 105 | 5 | 5.8 | 5 | 3 | 1 | .4 | 6.3 | 13 | 2219  
 VOLUME  
 91  
 FACTOR GROUP GR-05  
 3 DAYS  
 AVG WEEKDAY VOL 2219 X SEASONAL ADJ. FACTOR 1.0000 = ESTIMATED AVG DAILY TRAFFIC 2219  
 AWD 2-AXLE EQUIVALENT 2235

STATE OF WASHINGTON - DEPARTMENT OF TRANSPORTATION  
TRIP SYSTEM  
HOURLY TRAFFIC CLASSIFICATION SUMMARY

SR 500 MP 017.26 OFF SYSTEM ID. LEG 1 DIRECTION OF TRAFFIC NORTHBOUND LANE ALL OF

COUNT IDENTIFIER HPMS COUNTER NUMBER 168697 DESCRIPTION: ON SR 500 N/O SE LEADBETTER RD

04-14-08	CARS PICKUPS	BUS	SINGLE UNITS MED	UNITS HVY	4+	SINGLE UNIT %	DOUBLE UNITS 4-	5	6+	DOUBLE UNIT %	5-	TRAINS 6	7+	TRAIN %	TRUCK %	CLASS UNKNOWN	TOTAL VEHICLES
MONDAY																	
AM HOURS																	
12 - 1	99					5.7	1			.9				6.6			106
1 - 2	139	4				9.2								9.2			153
2 - 3	187	1				7.4								7.4			202
3 - 4	214	1				6.5	2			.9				7.4			231
4 - 5	227					3.4								3.4		1	236
5 - 6	150					6.8								6.8			162
6 - 7	98					5.8								5.8			104
7 - 8	98					3.0								3.0			101
8 - 9	79					4.8								4.8			83
9 - 10	34					2.9								2.9			35
10 - 11	15					11.8								11.8			17
11 - 12																	
AM TOTAL	1340	6	76	3	3	5.9	3			.2				6.2		2	1430
PM TOTAL	1340	6	76	3	3	5.9	3			.2				6.2		2	1430
DAY TOTAL	1340	6	76	3	3	5.9	3			.2				6.2		2	1435

2-AXLE EQUIVALENT







STATE OF WASHINGTON - DEPARTMENT OF TRANSPORTATION  
 TRIP SYSTEM  
 HOURLY TRAFFIC CLASSIFICATION SUMMARY

SR 500	MP 017.26	OFF SYSTEM ID.	LEG 1	DIRECTION OF TRAFFIC	NORThBOUND	LANE ALL OF												
COUNT IDENTIFIER	HPMS	COUNTER NUMBER	168697	DESCRIPTION: ON SR 500 N/O SE LEADBETTER RD														
04-17-08	THURSDAY	CARS PICKUPS	BUS	SINGLE MED	UNITS HVY	4+	SINGLE UNIT %	DOUBLE 4-	DOUBLE 5	DOUBLE 6+	DOUBLE UNIT %	5-	TRAINS 6	TRAINS 7+	TRAIN %	TRUCK %	CLASS UNKNOWN	TOTAL VEHICLES
12 -	1	7					10.0									10.0	1	30
1 -	2	3					2.6									2.6	1	39
2 -	3	3					7.4									7.4	1	68
3 -	4	4					3.2									3.2	1	125
4 -	5	5					4.1									4.1	2	140
5 -	6	6					5.7									5.7	1	125
6 -	7	7					4.1									4.1	2	217
7 -	8	8					5.7									5.7	1	140
8 -	9	9					3.2									3.2	1	125
9 -	10	10					7.4									7.4	1	68
10 -	11	11					2.6									2.6	1	39
11 -	12	12					10.0									10.0	1	30
PM HOURS																		
12 -	1	105					8.5									8.5	2	117
1 -	2	114					4.1									4.1	2	121
2 -	3	165					7.8									7.8	1	180
3 -	4	215					8.1									8.1	2	234
4 -	5	217					7.6									7.6	2	228
5 -	6	206					4.1									4.1	1	140
6 -	7	132					5.7									5.7	1	125
7 -	8	121					3.2									3.2	1	125
8 -	9	62					7.4									7.4	1	68
9 -	10	37					2.6									2.6	1	39
10 -	11	27					10.0									10.0	1	30
11 -	12																	
AM TOTAL		502	10	41	4		9.8	1	1	2	.7					10.5	2	563
PM TOTAL		1615	5	95	3		5.9	5	1	1	.3					6.3	12	1736
DAY TOTAL		2117	15	136	7		6.9	6	2	2	.4					7.3	14	2299
																		2316

2-AXLE EQUIVALENT

DOT-RNB505A-B

STATE OF WASHINGTON - DEPARTMENT OF TRANSPORTATION  
TRIP SYSTEM  
HOURLY TRAFFIC CLASSIFICATION SUMMARY

DATE 04/24/08  
TIME 10:35:11  
PAGE 100

SR 500 MP 017.26 OFF SYSTEM ID. LEG 1 DIRECTION OF TRAFFIC NORTHBOUND LANE ALL OF

COUNT IDENTIFIER HPMS COUNTER NUMBER 168697 DESCRIPTION: ON SR 500 N/O SE LEADBETTER RD

04-18-08	CARS PICKUPS	BUS MED	SINGLE UNITS 4+	SINGLE UNIT %	DOUBLE UNITS 4-5	DOUBLE UNITS 6+	DOUBLE UNIT %	5- TRAINS 6	7+ TRAINS 7+	TRAIN %	TRUCK %	CLASS UNKNOWN	TOTAL VEHICLES
FRIDAY	11												11
AM HOURS	11												11
12 - 1	11												11
1 - 2	5												5
2 - 3	4												4
3 - 4	3												4
4 - 5	8												9
5 - 6	26												36
6 - 7	68												80
7 - 8													
8 - 9													
9 - 10													
10 - 11													
11 - 12													
PM HOURS													
12 - 1													
1 - 2													
2 - 3													
3 - 4													
4 - 5													
5 - 6													
6 - 7													
7 - 8													
8 - 9													
9 - 10													
10 - 11													
11 - 12													

AM TOTAL	136	7	14	13.1	1		.6				13.8	2	160
PM TOTAL	136	7	14	13.1	1		.6				13.8	2	160
DAY TOTAL	136	7	14	13.1	1		.6				13.8	2	160

2-AXLE EQUIVALENT 161

04-14-08 THRU 04-18-08

AVERAGE WEEKDAY CLASSIFICATION VOLUMES	CARS PICKUPS	BUS MED	SINGLE UNITS 4+	SINGLE UNIT %	DOUBLE UNITS 4-5	DOUBLE UNITS 6+	DOUBLE UNIT %	5- TRAINS 6	7+ TRAINS 7+	TRAIN %	TRUCK %	CLASS UNKNOWN	TOTAL VEHICLES
AVG WEEKDAY VOLUME	2045	15	118	6.3	5	2	.4	1	1	.1	6.8	11	2208
AMD 2-AXLE EQUIVALENT 2225													

TOTAL HOURS FOR COUNT 91  
3 DAYS FACTOR GROUP GR-05  
AVG WEEKDAY VOL 2208 X SEASONAL ADJ. FACTOR 1.0000 = ESTIMATED AVG DAILY TRAFFIC 2208

SR 500 MP 017.26 OFF SYSTEM ID. LEG 1 DIRECTION OF TRAFFIC BOTH WAYS LANE ALL OF  
 COUNT IDENTIFIER HPMS COUNTER NUMBER 168697 DESCRIPTION: ON SR 500 N/O SE LEADBETTER RD

04-14-08	CARS PICKUPS	BUS	SINGLE MED	SINGLE UNITS HVY	4+	SINGLE UNIT %	DOUBLE UNITS 4-	5	6+	DOUBLE UNIT %	5-	6	7+	TRAIN %	TRUCK %	CLASS UNKNOWN	TOTAL VEHICLES
MONDAY	185	4	7	2		4.6	1			.5					5.1	2	197
AM HOURS	256	2	13	2		6.9									6.9		275
12 - 1	293		4			6.4									6.4		313
1 - 2	341	6	18			6.5	3			1.1					7.6	1	370
2 - 3	339		12			3.4		1		.3					3.7	2	354
3 - 4	263		8			5.0									5.0		278
4 - 5	161		6			4.7									4.7		169
5 - 6	158		5			3.7									3.7		164
6 - 7	100		2			4.8									4.8		105
7 - 8	51		2			3.8									3.8		53
8 - 9	21					8.7									8.7		23
9 - 10																	
10 - 11																	
11 - 12																	
AM TOTAL	2168	12	103	6		5.3	4	2		.3					5.5	6	2301
PM TOTAL																	
DAY TOTAL	2168	12	103	6		5.3	4	2		.3					5.5	6	2301
																	2311

2-AXLE EQUIVALENT





STATE OF WASHINGTON - DEPARTMENT OF TRANSPORTATION  
TRIP SYSTEM  
HOURLY TRAFFIC CLASSIFICATION SUMMARY

SR 500 MP 017.26 OFF SYSTEM ID. LEG 1 DIRECTION OF TRAFFIC BOTH WAYS LANE ALL OF

COUNT IDENTIFIER HPMS COUNTER NUMBER 168697 DESCRIPTION: ON SR 500 N/O SE LEADBETTER RD

04-17-08 THURSDAY AM HOURS	CARS PICKUPS	BUS	SINGLE MED	UNITS HVV	4+	SINGLE UNIT %	DOUBLE 4-	UNITS 5	6+	DOUBLE UNIT %	5-	TRAINS 6	7+	TRAIN %	TRUCK %	CLASS UNKNOWN	TOTAL VEHICLES
12 - 1	14		1			6.7									6.7		15
1 - 2	5																5
2 - 3	6																6
3 - 4	9																9
4 - 5	36																36
5 - 6	89																89
6 - 7	181	4		1		2.7	2		2.0				1	.3	2.7	3	210
7 - 8	279	8		1		12.9	1		1.0				1	.3	9.2	1	307
8 - 9	255	7		2		7.8	1		.7					.4	8.8	1	286
9 - 10	229	10		1		9.8	2		.7			1		.4	10.5	1	245
10 - 11	210	1		1		4.5	1		1.2					.4	6.1	4	229
11 - 12	216			1		5.7			.9						6.6		229
PM HOURS																	233
12 - 1	229			16		7.3									7.3		251
1 - 2	212			10		7.2			.4				1	.4	7.6	3	228
2 - 3	297	3		12		5.3	1		.4				1	.4	6.1	2	316
3 - 4	358	3		18		5.1	1		.6					.3	5.7	1	386
4 - 5	368	5		23		5.7	3		.8				1	.3	6.7	2	399
5 - 6	349			19		7.0	1		.3						7.3	2	371
6 - 7	323			11		5.1			.3						5.4	3	337
7 - 8	220			11		3.3			.3						3.3	2	231
8 - 9	177			5		4.8			.8						4.8	1	182
9 - 10	104			6		2.7			.7						2.7	1	111
10 - 11	57			1		5.4			.4						5.4	1	60
11 - 12	35			3		1.7			.7						1.7	2	38
AM TOTAL	1529	20		103		7.7	7		.8				1	.1	8.6	7	1680
PM TOTAL	2729	11		135		5.2	6		.3				2	.1	5.6	18	2910
DAY TOTAL	4258	31		238		6.1	13		.5				3	.1	6.7	25	4590
2-AXLE EQUIVALENT																	
4633																	



STATE OF WASHINGTON - DEPARTMENT OF TRANSPORTATION  
 TRIP SYSTEM  
 HOURLY TRAFFIC CLASSIFICATION SUMMARY

SR 500 MP 017.26 OFF SYSTEM ID. LEG 1 DIRECTION OF TRAFFIC BOTH WAYS LANE ALL OF  
 COUNT IDENTIFIER HPMS COUNTER NUMBER 168697 DESCRIPTION: ON SR 500 N/O SE LEADBETTER RD

FRIDAY AM HOURS	CARS PICKUPS	BUS	SINGLE MED	HVY	4+	SINGLE UNIT %	DOUBLE UNITS	4-	5	6+	DOUBLE UNIT %	5-	6	7+	TRAIN %	TRUCK %	CLASS UNKNOWN	TOTAL VEHICLES
12 - 1	15																	15
1 - 2	14																	14
2 - 3	8																	8
3 - 4	12																	12
4 - 5	27																	27
5 - 6	75																	75
6 - 7	178																	178
7 - 8	264																	264
8 - 9																		
9 - 10																		
10 - 11																		
11 - 12																		
PM HOURS																		
12 - 1																		
1 - 2																		
2 - 3																		
3 - 4																		
4 - 5																		
5 - 6																		
6 - 7																		
7 - 8																		
8 - 9																		
9 - 10																		
10 - 11																		
11 - 12																		
AM TOTAL	593	12	51	2		9.7	5	1			.9					10.6	3	667
PM TOTAL	593	12	51	2		9.7	5	1			.9					10.6	3	667
DAY TOTAL	593	12	51	2		9.7	5	1			.9					10.6	3	667

04-14-08 THRU 04-18-08

AVERAGE WEEKDAY CLASSIFICATION VOLUMES \*\*\*\*\*  
 CARS | SINGLE UNITS | DOUBLE UNITS | DOUBLE UNIT % | TRAINS | TRUCK | CLASS UNKNOWN | TOTAL VEHICLES  
 PICKUPS | BUS MED HVY 4+ | 4- 5 6+ | 5- 6 7+ | TRAIN % | TRUCK % | UNKNOW  
 AVG WEEKDAY VOLUME 4112 35 223 10 2 6.1 11 5 2 .4 1 1 2 .1 6.6 23 4427  
 TOTAL HOURS FOR COUNT 91  
 3 DAYS FACTOR GROUP GR-05  
 AVG WEEKDAY VOL 4427 X SEASONAL ADJ. FACTOR 1.0000 = ESTIMATED AVG DAILY TRAFFIC 4427  
 PEAK HOUR PERCENTAGES: K = 9.01 D = 59.40 T = 7.27  
 PEAK HOUR LOCATION : VOLUME = 399 DATE: 04/17/08 TIME: 04:00 PM

0.9915

Note: Count Low