



Interval 60 min. 15 min.
 Binned(CL/SP) Count(volume)
Lane No 1 2

Direction Channel 1 _____
Direction Channel 2 _____
Unique ID# _____

Counter No. 295875 Count ID HPMS
SR 501 RRT/RRQ MP 16.91
Leg 2 Direction WB ~~EB~~ OSID _____

Station Description _ ON SR 501 E/O Main st.

S MAIN ST / N MAIN ST

Date	Day	Time	Comments			
7/16/18 717118	2	09:45	Manual (1) <u>1</u> (2) _____ Counter (1) <u>1</u> (2) _____	Set up ok	JDM	6.3v
7/17/18 718118	3	13:28	Manual (1) <u>8</u> (2) _____ Counter (1) <u>8</u> (2) _____	Check ok	JDM	6.8v
7/18/18 719118	4	05:45	Manual (1) <u>3</u> (2) _____ Counter (1) <u>3</u> (2) _____	Check ok	JDM	6.2v
7/20/18 719118	5	08:25	Manual (1) <u>8</u> (2) _____ Counter (1) <u>8</u> (2) _____	Check ok	JDM	6.8v
7/21/18 7/20/18	6	08:48	Manual (1) <u>1</u> (2) _____ Counter (1) <u>1</u> (2) _____	P/U ok	JDM	6.2v

Sketch

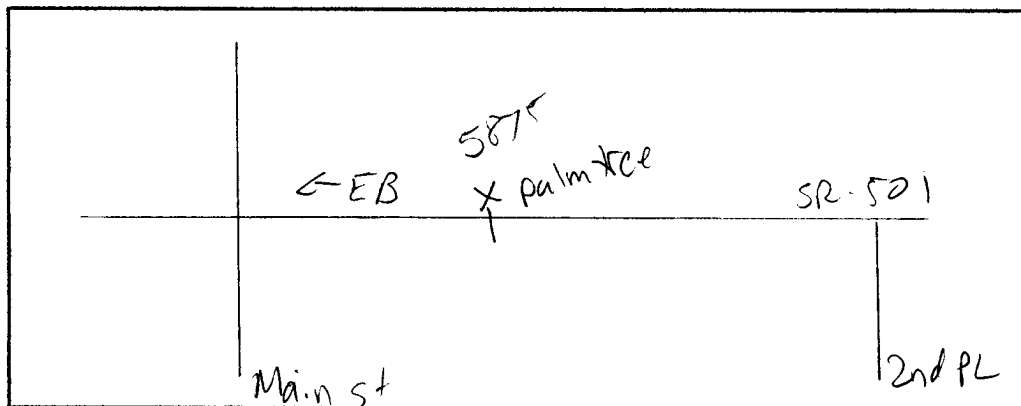

North

J. Mylka
Field Person

Interval 60 min. 15 min.
 Binned(CL/SP) Count(volume)
Lane No 1 2

Direction Channel 1 _____
Direction Channel 2 _____
Unique ID# _____

Counter No. 294643 Count ID HPMS
SR 501 RRT/RRQ MP 16.91
Leg 2 Direction EB OSID _____
~~WB~~

Station Description ON SR 501 E/O Main st

S MAIN ST / N MAIN ST

Date	Day	Time	Comments
7/16/18 7/17/18	2	09:51	Manual (1) <u>1</u> (2) _____ Set up ok JDM 6.4v Counter (1) <u>1</u> (2) _____
7/17/18 7/18/18	3	13:29	Manual (1) <u>7</u> (2) _____ Check ok JDM 6.7v Counter (1) <u>7</u> (2) _____
7/18/18 7/19/18	4	05:45	Manual (1) <u>4</u> (2) _____ Check ok JDM 6.5v Counter (1) <u>4</u> (2) _____
7/20/18 7/19/18	5	08:25	Manual (1) <u>4</u> (2) _____ Check ok JDM Counter (1) <u>4</u> (2) _____ <i>Tube up, split in half 08:25</i>
7/21/18 7/20/18	6	08:48	Manual (1) <u>1</u> (2) _____ P/U ok JDM 6.5v Counter (1) <u>1</u> (2) _____

Sketch

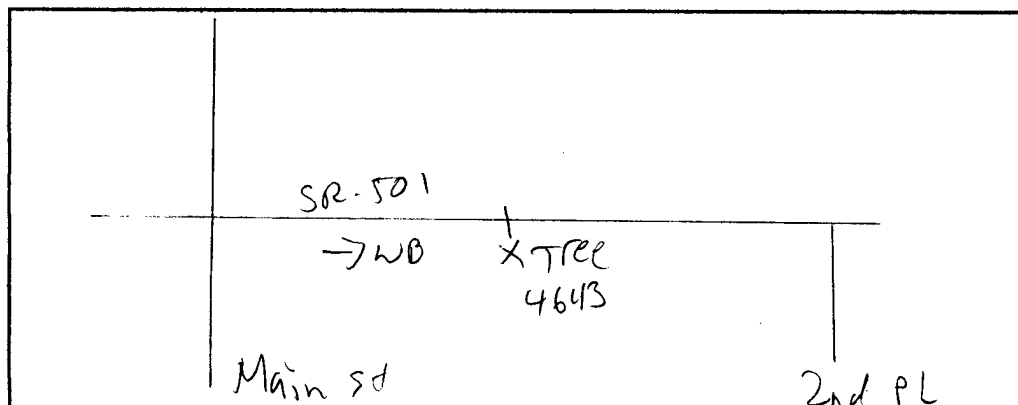

J. Myllar
Field Person

STATE OF WASHINGTON - DEPARTMENT OF TRANSPORTATION
T R I P S S Y S T E M
15 MINUTE TRAFFIC COUNT SUMMARY

SR 501	MP 016.91	OFF SYSTEM ID.	LEG 2	DIRECTION OF TRAFFIC WESTBOUND												LANE ALL OF										
COUNT IDENTIFIER	HPMS	COUNTER NUMBER	295875	DESCRIPTION: ON SR 501 E/O S MAIN ST/N MAIN ST																						
07/16/18 MONDAY			AM HOURS									PM HOURS									DAILY					
	12	1	2	3	4	5	6	7	8	9	10	11	12	1	2	3	4	5	6	7	8	9	10	11	12	TOTAL
00-15											24	39	45	24	23	30	29	34	28	18	17	11	8	2		
15-30											21	26	33	25	24	51	50	31	39	27	15	8	4	5		
30-45											28	31	37	35	22	29	35	31	43	21	12	9	2	2		
45-00											25	33	26	29	18	28	37	54	22	20	21	5	3			
HOUR	-----																									
TOT											98	129	141	113	87	138	151	150	132	86	65	33	17	9	1349	

AM PEAK HOUR 1100 TO 1200 VOLUME 129 AM TOTAL 227
PM PEAK HOUR 0545 TO 0645 VOLUME 164 PM TOTAL 1122

07/17/18 TUESDAY			AM HOURS									PM HOURS									DAILY					
	12	1	2	3	4	5	6	7	8	9	10	11	12	1	2	3	4	5	6	7	8	9	10	11	12	TOTAL
00-15	2	1				2	4	15	18	33	39	33	32	44	34	38	31	52	34	21	16	15	8	3		
15-30	2	1	1			4	10	5	13	34	34	37	22	33	31	40	35	44	41	36	15	11	3	4		
30-45	2	1		2		2	11	20	13	14	27	25	24	31	26	17	38	49	35	34	11	10	3	4		
45-00	1	1		1	1	5	9	17	24	24	31	41	43	31	29	51	45	38	37	32	19	10	3	4		
HOUR	-----																									
TOT	7	4	1	3	1	13	34	57	68	105	131	136	121	139	120	146	149	183	147	123	61	46	17	15	1827	

AM PEAK HOUR 1100 TO 1200 VOLUME 136 AM TOTAL 560
PM PEAK HOUR 0445 TO 0545 VOLUME 190 PM TOTAL 1267

07/18/18 WEDNESDAY			AM HOURS									PM HOURS									DAILY					
	12	1	2	3	4	5	6	7	8	9	10	11	12	1	2	3	4	5	6	7	8	9	10	11	12	TOTAL
00-15		2		1	1	2	5	12	18	15	32	26	43	36	35	44	30	49	42	26	19	19	6	4		
15-30			1			7	9	13	14	20	28	31	36	39	41	41	34	42	13	28	24	8	3	2		
30-45				1	1	4	8	10	12	28	30	30	36	37	29	49	38	35	33	34	21	13	5	4		
45-00	2	2	1	1	1	3	7	26	19	30	24	26	41	38	45	52	29	38	28	25	20	6	4	2		
HOUR	-----																									
TOT	2	4	3	2	3	16	29	61	63	93	114	113	156	150	150	186	131	164	116	113	84	46	18	12	1829	

AM PEAK HOUR 0945 TO 1045 VOLUME 120 AM TOTAL 503
PM PEAK HOUR 0300 TO 0400 VOLUME 186 PM TOTAL 1326

STATE OF WASHINGTON - DEPARTMENT OF TRANSPORTATION
 TRIP SYSTEM
 15 MINUTE TRAFFIC COUNT SUMMARY

SR 501	MP 016.91	OFF SYSTEM ID.	LEG 2	DIRECTION OF TRAFFIC WESTBOUND																	LANE ALL OF						
COUNT IDENTIFIER	HPMS	COUNTER NUMBER	295875	DESCRIPTION: ON SR 501 E/O S MAIN ST/N MAIN ST																							
07/19/18 THURSDAY			AM HOURS												PM HOURS												DAILY
	12	1	2	3	4	5	6	7	8	9	10	11	12	1	2	3	4	5	6	7	8	9	10	11	12	TOTAL	
00-15	4			1		2	3	16	16	9	21	29	42	28	38	28	42	34	27	39	16	15	6				
15-30	2				5	9	10	18	19	19	29	45	29	36	42	44	42	42	26	15	9	10		3			
30-45	2	1	2		1	4	8	10	21	28	43	33	41	37	45	27	34	40	38	22	29	10	2	6			
45-00	1			2	2	5	8	20	22	23	26	28	38	20	33	45	51	40	29		18	9	3	3			
HOUR	-----																										
TOT	9	1	2	3	3	16	28	56	77	79	109	119	166	114	152	142	171	156	136	87	78	43	21	12	1780		

AM PEAK HOUR 1030 TO 1130 VOLUME 127 AM TOTAL 502
 PM PEAK HOUR 0400 TO 0500 VOLUME 171 PM TOTAL 1278

07/20/18 FRIDAY			AM HOURS												PM HOURS												DAILY
	12	1	2	3	4	5	6	7	8	9	10	11	12	1	2	3	4	5	6	7	8	9	10	11	12	TOTAL	
00-15	1	1	1		1	1	11	7	14																		
15-30	2		1	2	5	2	9	11	8																		
30-45	2	3	1	1	1	1	7	12	13																		
45-00	3		1			6	3	17																			
HOUR	-----																										
TOT	8	4	4	3	7	10	30	47	35																148		

AM PEAK HOUR 0715 TO 0815 VOLUME 54 AM TOTAL 148
 PM PEAK HOUR 0000 TO 0000 VOLUME 0 PM TOTAL 0

07/16/18 THRU 07/20/18
 TOTAL HOURS FOR COUNT 92

3 DAYS FACTOR GROUP GR-02
 AVG WEEKDAY VOL 1812 X SEASONAL ADJ. FACTOR 0.9300 = 1685 X AXLE CORR FACTOR 0.9807 = ESTIMATED AVG DAILY TRAFFIC 1652

STATE OF WASHINGTON - DEPARTMENT OF TRANSPORTATION
TRIPS SYSTEM
15 MINUTE TRAFFIC COUNT SUMMARY

SR 501	MP 016.91	OFF SYSTEM ID.	LEG 2	DIRECTION OF TRAFFIC EASTBOUND												LANE ALL	OF							
COUNT IDENTIFIER	HPMS	COUNTER NUMBER	294643	DESCRIPTION: ON SR 501 E/O S MAIN ST/N MAIN ST																				
07/16/18 MONDAY												AM HOURS						PM HOURS						DAILY
12	1	2	3	4	5	6	7	8	9	10	11	12	1	2	3	4	5	6	7	8	9	10	11	TOTAL
1	2	3	4	5	6	7	8	9	10	11	12	1	2	3	4	5	6	7	8	9	10	11	12	
00-15										35	26	36	18	27	28	29	27	18	16	14	8	9	3	
15-30										17	24	20	37	21	34	40	19	26	19	9	8	6	3	
30-45										35	21	29	21	23	21	33	21	20	19	15	10	3	4	
45-00										16	28	26	18	26	33	28	24	19	10	20	7		2	
HOUR	-----																							
TOT										103	99	111	94	97	116	130	91	83	64	58	33	18	12	1109

AM PEAK HOUR 1000 TO 1100 VOLUME 103 AM TOTAL 202
 PM PEAK HOUR 0345 TO 0445 VOLUME 135 PM TOTAL 907

07/17/18 TUESDAY												AM HOURS						PM HOURS						DAILY	
12	1	2	3	4	5	6	7	8	9	10	11	12	1	2	3	4	5	6	7	8	9	10	11	TOTAL	
1	2	3	4	5	6	7	8	9	10	11	12	1	2	3	4	5	6	7	8	9	10	11	12		
00-15	1	1	2	7	4	21	20	26	29	17	23	27	30	36	32	35	23	15	13	11	3	2			
15-30	1	2	1	7	13	17	19	24	36	18	29	21	20	26	29	27	23	18	17	6	1	2			
30-45	1	1	2	7	19	26	15	20	22	21	37	30	26	17	21	35	31	20	19	7	3	2			
45-00	1	1	1	3	7	4	11	19	19	22	32	32	24	21	33	37	26	29	19	17	12	3	1		
HOUR	-----																								
TOT	4	3	3	6	10	25	47	83	73	92	119	88	113	99	109	116	108	126	96	70	61	27	8	7	1493

AM PEAK HOUR 1000 TO 1100 VOLUME 119 AM TOTAL 553
 PM PEAK HOUR 0500 TO 0600 VOLUME 126 PM TOTAL 940

07/18/18 WEDNESDAY												AM HOURS						PM HOURS						DAILY
12	1	2	3	4	5	6	7	8	9	10	11	12	1	2	3	4	5	6	7	8	9	10	11	TOTAL
1	2	3	4	5	6	7	8	9	10	11	12	1	2	3	4	5	6	7	8	9	10	11	12	
00-15	3			1	2	6	7	22	23	19	37	27	29	25	27	37	2							
15-30	1	1		1	2	8	13	14	15	27	28	27	32	39	43	36		3			1			
30-45		1	1	1	1	9	12	16	21	27	26	16	30	26	23	13			8		1			
45-00				3	5	6	15	17	22	26	10	28	28	21	24		4							
HOUR	-----																							
TOT	4	2	1	6	10	29	47	69	81	99	101	98	119	111	117	86	6	3	8	2				999

AM PEAK HOUR 0930 TO 1030 VOLUME 118 AM TOTAL 547
 PM PEAK HOUR 0215 TO 0315 VOLUME 127 PM TOTAL 432

TUBE UP

STATE OF WASHINGTON - DEPARTMENT OF TRANSPORTATION
TRIP SYSTEM
15 MINUTE TRAFFIC COUNT SUMMARY

SR 501	MP 016.91	OFF SYSTEM ID.	LEG 2	DIRECTION OF TRAFFIC EASTBOUND														LANE ALL	OF						
COUNT IDENTIFIER	HPMS	COUNTER NUMBER	294643	DESCRIPTION: ON SR 501 E/O S MAIN ST/N MAIN ST																					
07/19/18 THURSDAY												PM HOURS												DAILY	
AM HOURS																								TOTAL	
12	1	2	3	4	5	6	7	8	9	10	11	12	1	2	3	4	5	6	7	8	9	10	11	12	
00-15									20	24	24	28	23	23	26	45	27	22	14	7	21	6	4		
15-30								4	15	23	26	27	30	28	32	33	25	15	13	20	6	6	4		
30-45								20	26	27	19	35	27	37	23	23	31	17	20	19	10	5	1		
45-00								22	34	22	14	28	13	26	23	33	23	18	26	19	5	1	1		
HOUR	-----																								
TOT								46	95	96	83	118	93	114	104	134	106	72	73	65	42	18	10	1269	

TUBE UP

AM PEAK HOUR 0945 TO 1045 VOLUME 108
PM PEAK HOUR 0400 TO 0500 VOLUME 134

AM TOTAL 320
PM TOTAL 949

07/20/18 FRIDAY												PM HOURS												DAILY	
AM HOURS																								TOTAL	
12	1	2	3	4	5	6	7	8	9	10	11	12	1	2	3	4	5	6	7	8	9	10	11	12	
00-15	5	1	1		3	6	9	16	17																
15-30	5	1	1	1	2	8	18	13	15																
30-45		2	2	1	3	6	11	26	20																
45-00	4		2	1	2	9	22	14																	
HOUR	-----																								
TOT	14	4	6	3	10	29	60	69	52																247

AM PEAK HOUR 0645 TO 0745 VOLUME 77
PM PEAK HOUR 0000 TO 0000 VOLUME 0

AM TOTAL 247
PM TOTAL 0

07/16/18 THRU 07/20/18
TOTAL HOURS FOR COUNT 81

2 DAYS *1495* FACTOR GROUP GR-02 *1390* FACTOR GROUP GR-B2 *1363*
 AVG WEEKDAY VOL 1474 X SEASONAL ADJ. FACTOR 0.9300 = 1371 X AXLE CORR FACTOR 0.9807 = ESTIMATED AVG DAILY TRAFFIC 1345

STATE OF WASHINGTON - DEPARTMENT OF TRANSPORTATION
T R I P S S Y S T E M
15 MINUTE TRAFFIC COUNT SUMMARY

SR 501	MP 016.91	OFF SYSTEM ID.	LEG 2	DIRECTION OF TRAFFIC BOTH WAYS												LANE ALL OF									
COUNT IDENTIFIER	HPMS	COUNTER NUMBER	294643	DESCRIPTION: ON SR 501 E/O S MAIN ST/N MAIN ST																					
07/16/18 MONDAY			AM HOURS						PM HOURS																
	12	1	2	3	4	5	6	7	8	9	10	11	12	1	2	3	4	5	6	7	8	9	10	11	DAILY TOTAL
00-15											59	65	81	42	50	58	58	61	46	34	31	19	17	5	
15-30											38	50	53	62	45	85	90	50	65	46	24	16	10	8	
30-45											63	52	66	56	45	50	68	52	63	40	27	19	5	6	
45-00											41	61	52	47	44	61	65	78	41	30	41	12	3	2	
HOUR	-----																								
TOT											201	228	252	207	184	254	281	241	215	150	123	66	35	21	2458

AM PEAK HOUR 1100 TO 1200 VOLUME 228 AM TOTAL 429
PM PEAK HOUR 0415 TO 0515 VOLUME 284 PM TOTAL 2029

07/17/18 TUESDAY			AM HOURS						PM HOURS																									
	12	1	2	3	4	5	6	7	8	9	10	11	12	1	2	3	4	5	6	7	8	9	10	11	DAILY TOTAL									
00-15											3	2	2	9	8	36	38	59	68	50	55	71	64	74	63	87	57	36	29	26	11	5		
15-30											3	1	3	1	2	11	23	22	32	58	70	55	51	54	51	66	64	71	64	54	32	17	4	6
30-45											3	2	3	2	1	9	30	46	28	34	49	46	61	61	52	34	59	84	66	54	30	17	6	6
45-00											2	2	1	4	8	9	20	36	43	46	63	73	67	52	62	88	71	67	56	49	31	13	4	5
HOUR	-----																																	
TOT	11	7	4	9	11	38	81	140	141	197	250	224	234	238	229	262	257	309	243	193	122	73	25	22	3320									

AM PEAK HOUR 1000 TO 1100 VOLUME 250 AM TOTAL 1113
PM PEAK HOUR 0445 TO 0545 VOLUME 313 PM TOTAL 2207

07/18/18 WEDNESDAY			AM HOURS						PM HOURS																									
	12	1	2	3	4	5	6	7	8	9	10	11	12	1	2	3	4	5	6	7	8	9	10	11	DAILY TOTAL									
00-15											3	2	2	3	8	12	34	41	34	69	53	72	61	62	81	32	49	42	26	19				
15-30											1	1	1	1	2	15	22	27	29	47	56	58	68	78	84	77	34	45	13	28	25			
30-45											1	1	2	1	2	13	20	26	33	55	56	46	66	63	52	62	38	35	41	34	22			
45-00											2	2	1	4	6	9	22	43	41	56	34	54	69	59	69	52	33	38	28	25	20			
HOUR	-----																																	
TOT	6	6	4	8	13	45	76	130	144	192	215	211	275	261	267	272	137	167	124	113	86													2752

AM PEAK HOUR 0945 TO 1045 VOLUME 237 TUBE UP EB AM TOTAL 1050
PM PEAK HOUR 0245 TO 0345 VOLUME 289 PM TOTAL 1702

STATE OF WASHINGTON - DEPARTMENT OF TRANSPORTATION
TRIPS SYSTEM
15 MINUTE TRAFFIC COUNT SUMMARY

SR 501	MP 016.91	OFF SYSTEM ID.	LEG 2	DIRECTION OF TRAFFIC BOTH WAYS	LANE ALL OF																					
COUNT IDENTIFIER	HPMS	COUNTER NUMBER	DESCRIPTION: ON SR 501 E/O S MAIN ST/N MAIN ST																							
07/19/18 THURSDAY				AM HOURS						PM HOURS																
	12	1	2	3	4	5	6	7	8	9	10	11	12	1	2	3	4	5	6	7	8	9	10	11	12	DAILY TOTAL
00-15										16	29	45	53	70	51	61	54	87	61	49	53	23	36	12	4	
15-30										22	34	42	55	72	59	64	74	77	67	57	39	35	15	16	7	
30-45										41	54	70	52	76	64	82	50	57	71	55	42	48	20	7	7	
45-00										44	57	48	42	66	33	59	68	84	63	47	26	37	14	4	4	
HOUR	-----																									
TOT										123	174	205	202	284	207	266	246	305	262	208	160	143	85	39	22	2931

TUBE UP EB

AM PEAK HOUR 1030 TO 1130 VOLUME 226 AM TOTAL 704
 PM PEAK HOUR 0400 TO 0500 VOLUME 305 PM TOTAL 2227

07/20/18 FRIDAY				AM HOURS						PM HOURS																
	12	1	2	3	4	5	6	7	8	9	10	11	12	1	2	3	4	5	6	7	8	9	10	11	12	DAILY TOTAL
00-15	6	2	2		4	7	20	23	31																	
15-30	7	1	2	3	7	10	27	24	23																	
30-45	2	5	3	2	4	7	18	38	33																	
45-00	7		3	1	2	15	25	31																		
HOUR	-----																									
TOT	22	8	10	6	17	39	90	116	87																	395

AM PEAK HOUR 0715 TO 0815 VOLUME 124 AM TOTAL 395
 PM PEAK HOUR 0000 TO 0000 VOLUME 0 PM TOTAL 0

07/16/18 THRU 07/20/18
TOTAL HOURS FOR COUNT 81

2 DAYS 3299 FACTOR GROUP GR-02 3068 FACTOR GROUP GR-B2 3009
 AVG WEEKDAY VOL 3200 X SEASONAL ADJ. FACTOR 0.9300 = 2976 X AXLE CORR FACTOR 0.9807 = ESTIMATED AVG DAILY TRAFFIC 2919

PEAK HOUR PERCENTAGES: K = 9.49 D = 60.70
 PEAK HOUR LOCATION : VOLUME = 313 DATE: 07/17/18 TIME: 04:45 PM